



Automatic doors for elevators

LANDING DOORS

SERIE Q DIN 18091

(06)

PRISMA S.r.l.

Quartiere Artigianale
I-43055 Casale di Mezzani (Pr) Italy
Tel. +39 0521 3164.11
Fax +39 0521 3164.333
e-mail: sales@prismaitaly.it
www.prismaitaly.it

Production Unit:

- 1) Pessano con Bornago (Mi) Italy
- 2) Casale di Mezzani (Pr) Italy



INDEX

L1S/R-L	□□ 03 □□
L2C SMALL	□□ 04 □□
L2C	□□ 05 □□
L2S /R-L SMALL	□□ 06 □□
L2S /R-L	□□ 07 □□
L4C SMALL	□□ 08 □□
L4C	□□ 09 □□
L3S /R-L SMALL	□□ 10 □□
L3S /R-L	□□ 11 □□
L6C SMALL	□□ 12 □□
L6C	□□ 13 □□

L1S /R-L

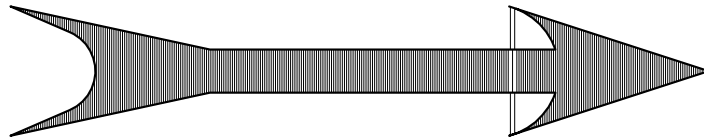

Serie "Q" DIN 18091

STANDARD

01_06_00_01REV00



L1S/...

A 500 - 1000

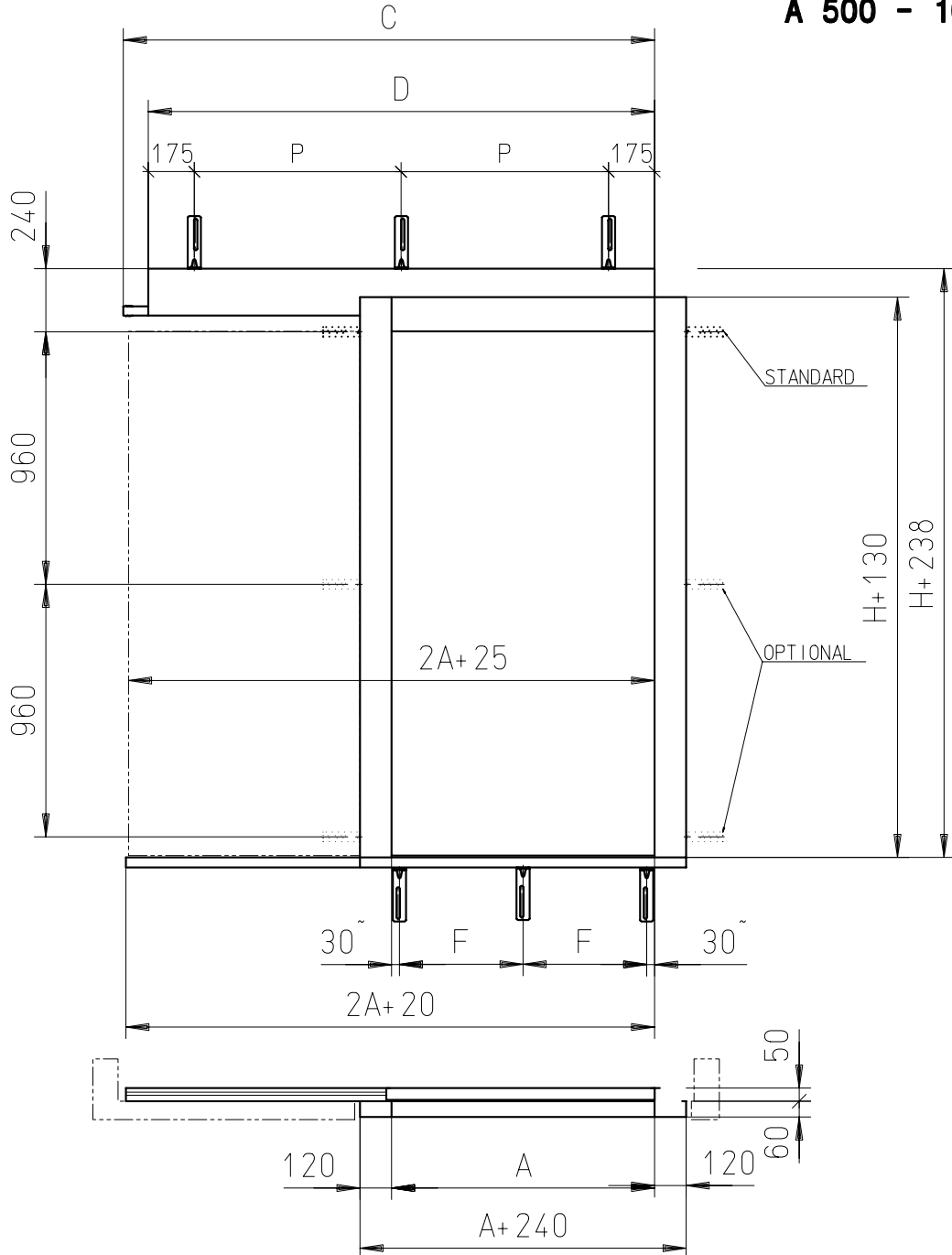

A	500	550	600	650	700	750	800	850	900	950	1000
C	1039	1139	1239	1339	1439	1539	1639	1739	1839	1939	2039
D	835	835	1203	1203	1203	1503	1503	1503	1803	1803	1803
F	220	245	270	295	320	345	370	395	420	445	313
	NR. 3									NR. 4	
P	0	0	425	425	425	575	575	575	362.5	362.5	362.5
	NR. 2		NR. 3					NR. 5			

Serie "Q" DIN 18091

FIXING STANDARD

01_06_00_01REV00



L1S/...

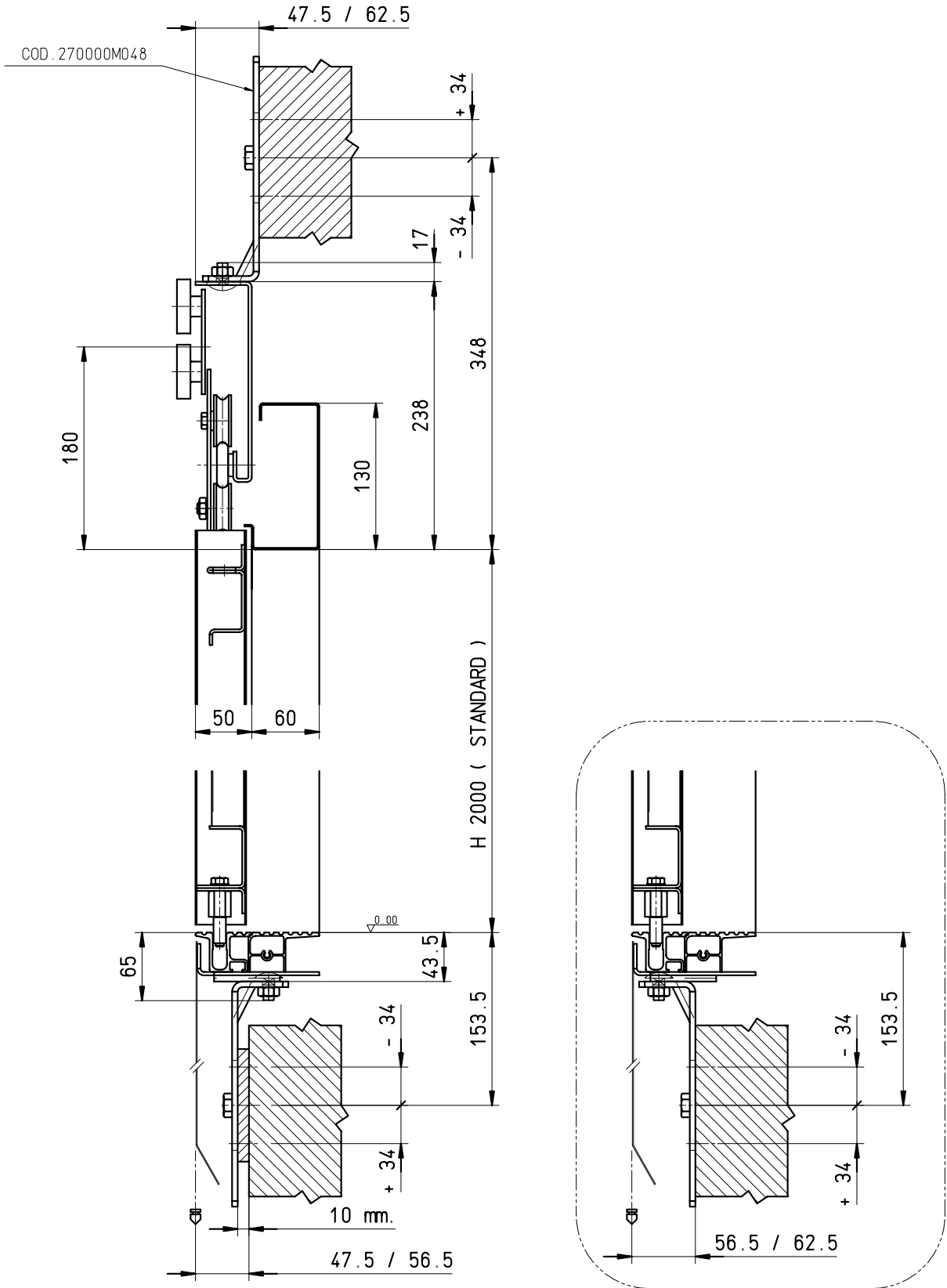

Serie "Q"

FIXING WITH UNI STRUTS

01_06_00_01REV00



L1S/...

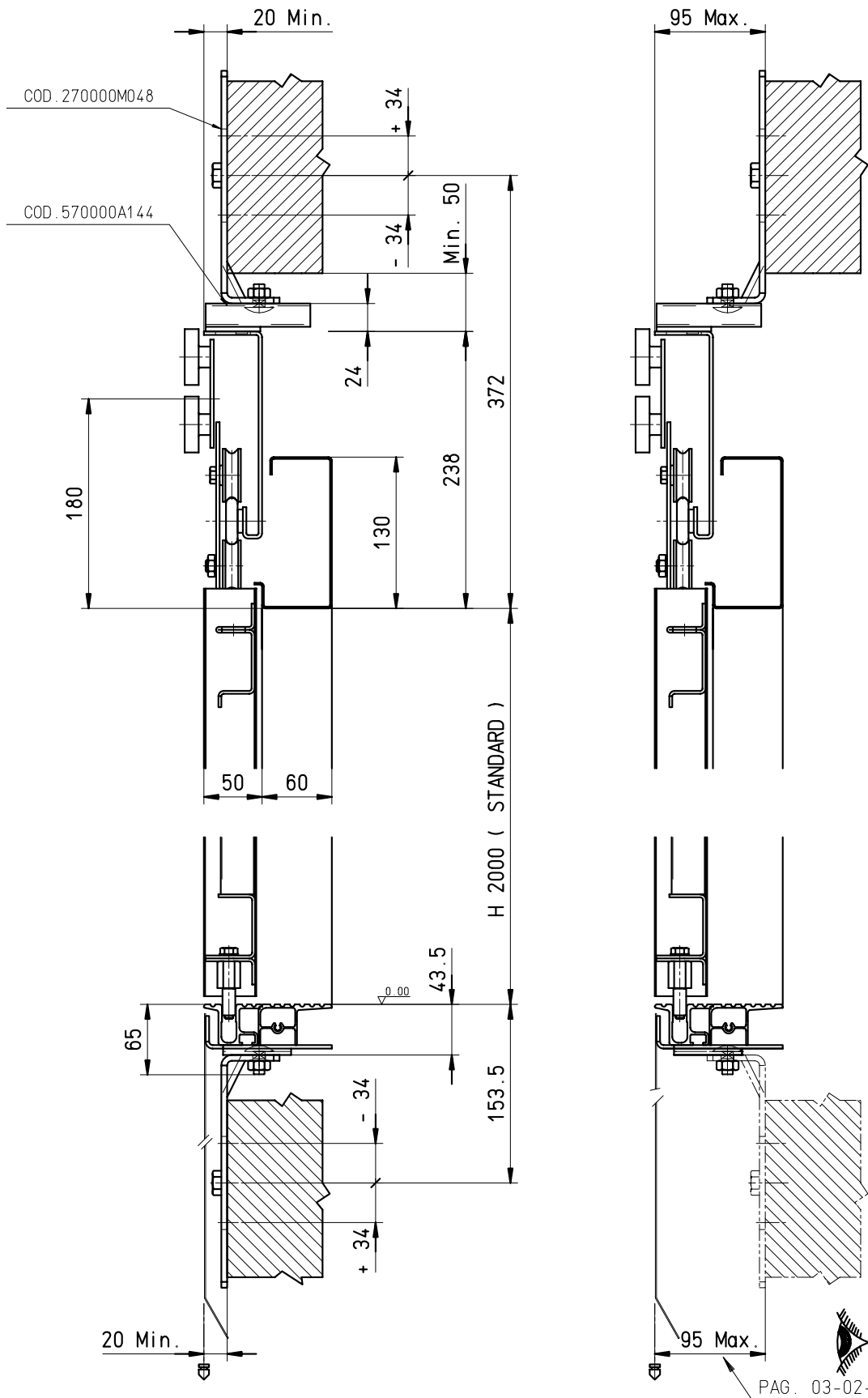

**L2C
SMALL**

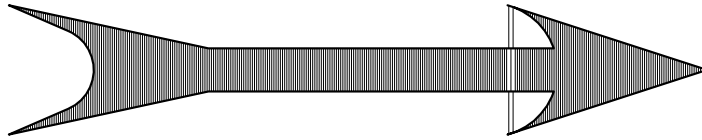

Serie "Q" DIN 18091 SMALL

STANDARD

01_06_00_01REV00

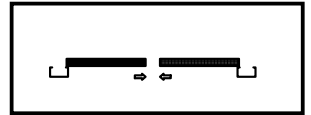

L2C

A 500 - 550

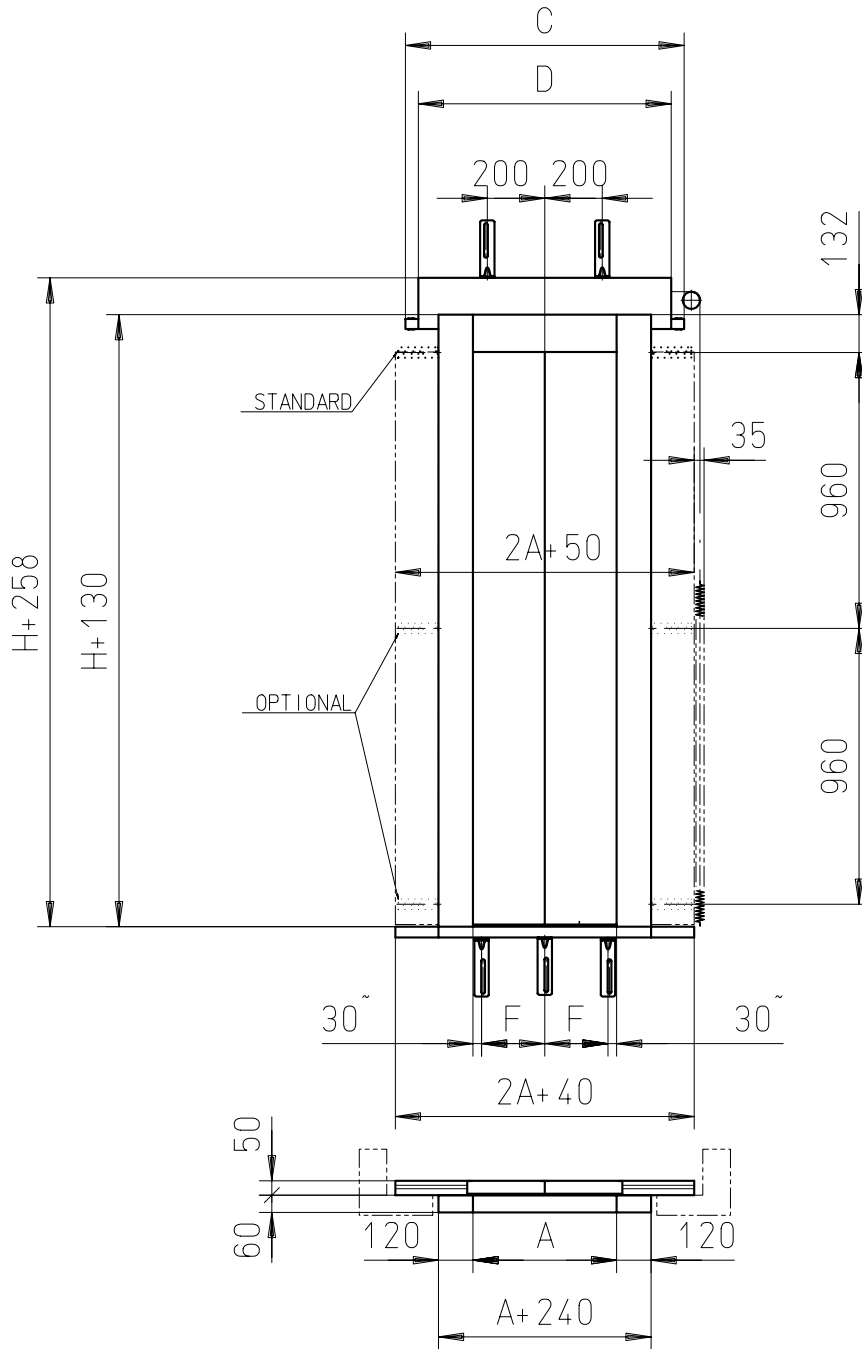

SMALL

A	500	550
C	1088	1138
D	900	900
F	220	245
	NR. 3	

Serie "Q" DIN 18091 SMALL

FIXING STANDARD

01_06_00_01REV00

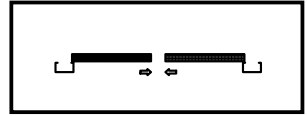

L2C

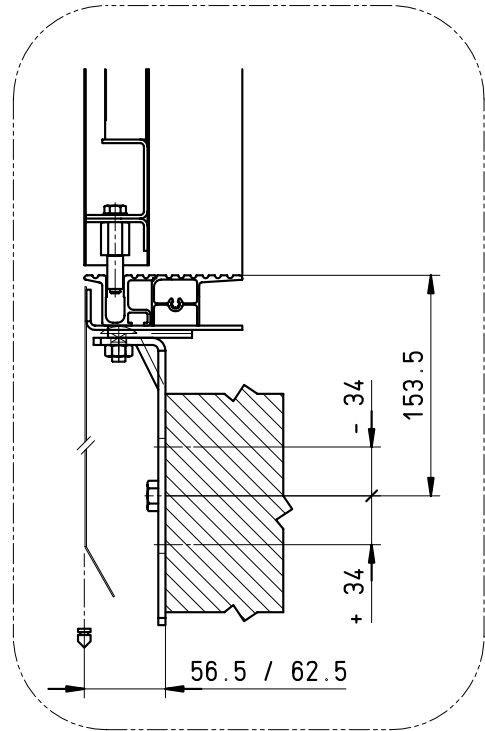
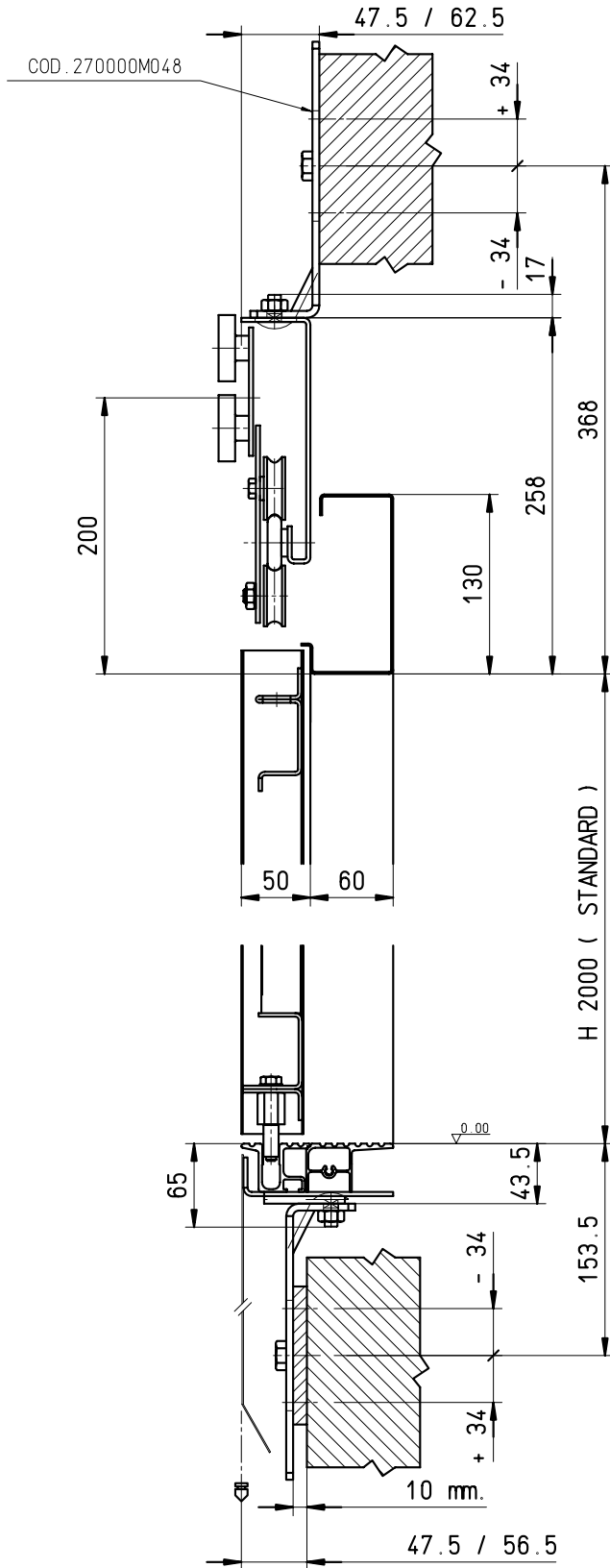

SMALL

Serie "Q" DIN 18091 SMALL

FIXING WHIT UNI STRUTS

01_06_00_01REV00

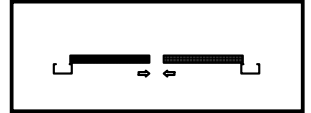

L2C

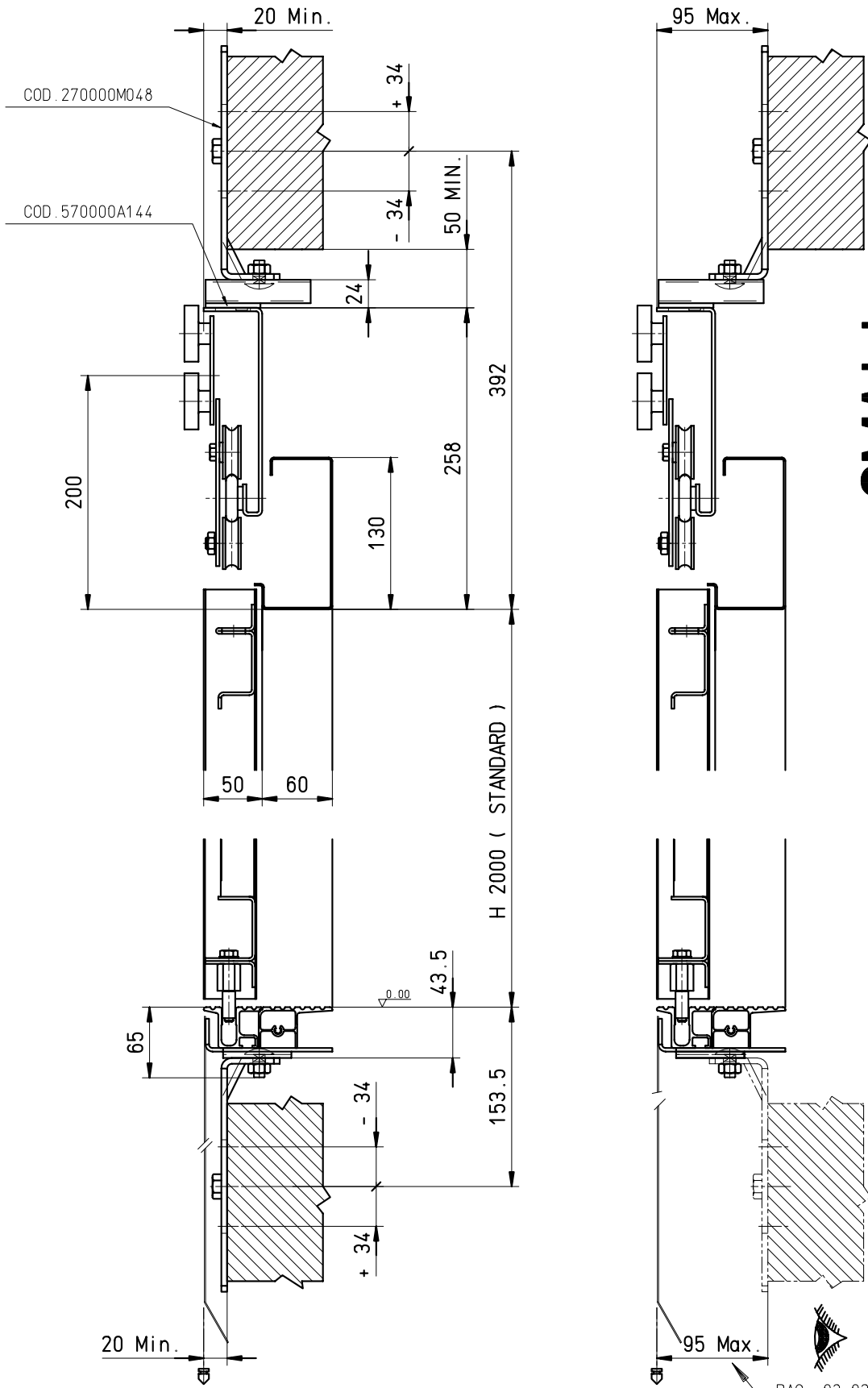

PAG. 03-02-03

L2C

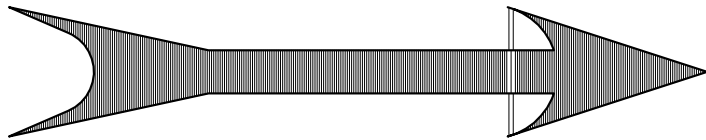

Serie "Q" DIN 18091

STANDARD

01_06_00_01REV00

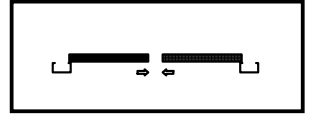

L2C

A 600 - 2000

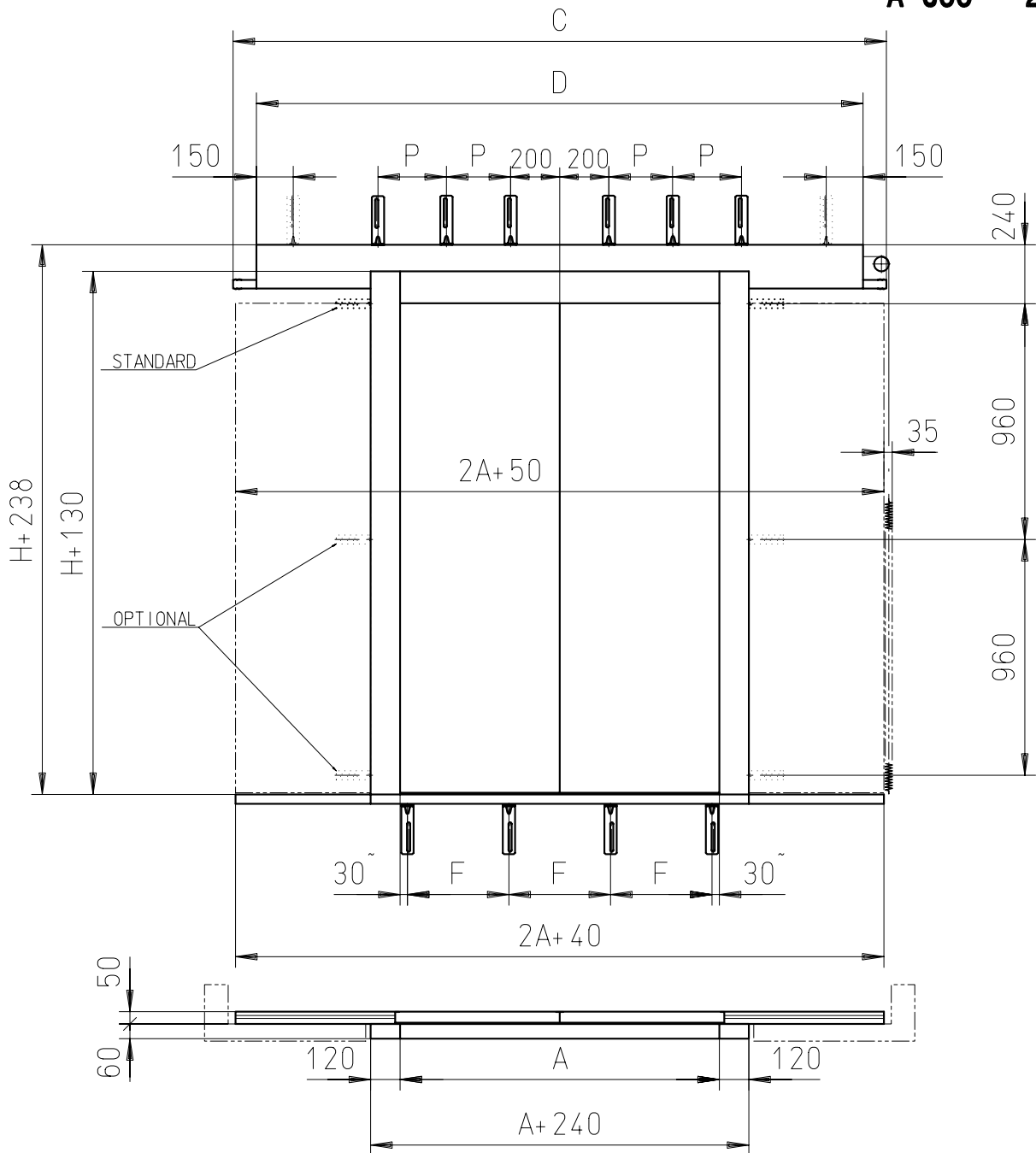

A	600	650	700	750	800	850	900	950	1000	1050	1100	1150	1200	1250	1300	1350	1400	1450	1500	1550	1600	1650	1700	1750	1800	1850	1900	1950	2000
C	1288	1338	1472	1522	1678	1728	1878	1928	2078	2128	2278	2328	2478	2528	2678	2728	2878	2928	3078	3128	3278	3328	3478	3528	3678	3728	3878	3928	4078
D	900	900	1270	1270	1270	1270	1670	1670	1670	1670	2070	2070	2070	2070	2470	2470	2470	2470	2870	2870	2870	2870	3270	3270	3270	3270	3670	3670	3670
F	270	295	320	345	370	395	420	445	313	330	346	363	380	396	413	430	447	347	360	372	385	397	410	422	435	447	368	378	388
	NR. 3								NR. 4								NR. 5								NR. 6				
P	0	0	0	0	0	0	0	0	0	0	350	350	350	350	450	450	450	450	550	550	550	550	430	430	430	430	500	500	500
	NR. 2		NR. 4								NR. 6								NR. 8										

Serie "Q" DIN 18091

FIXING STANDARD

01_06_00_01REV00

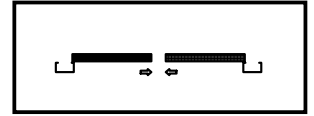

L2C

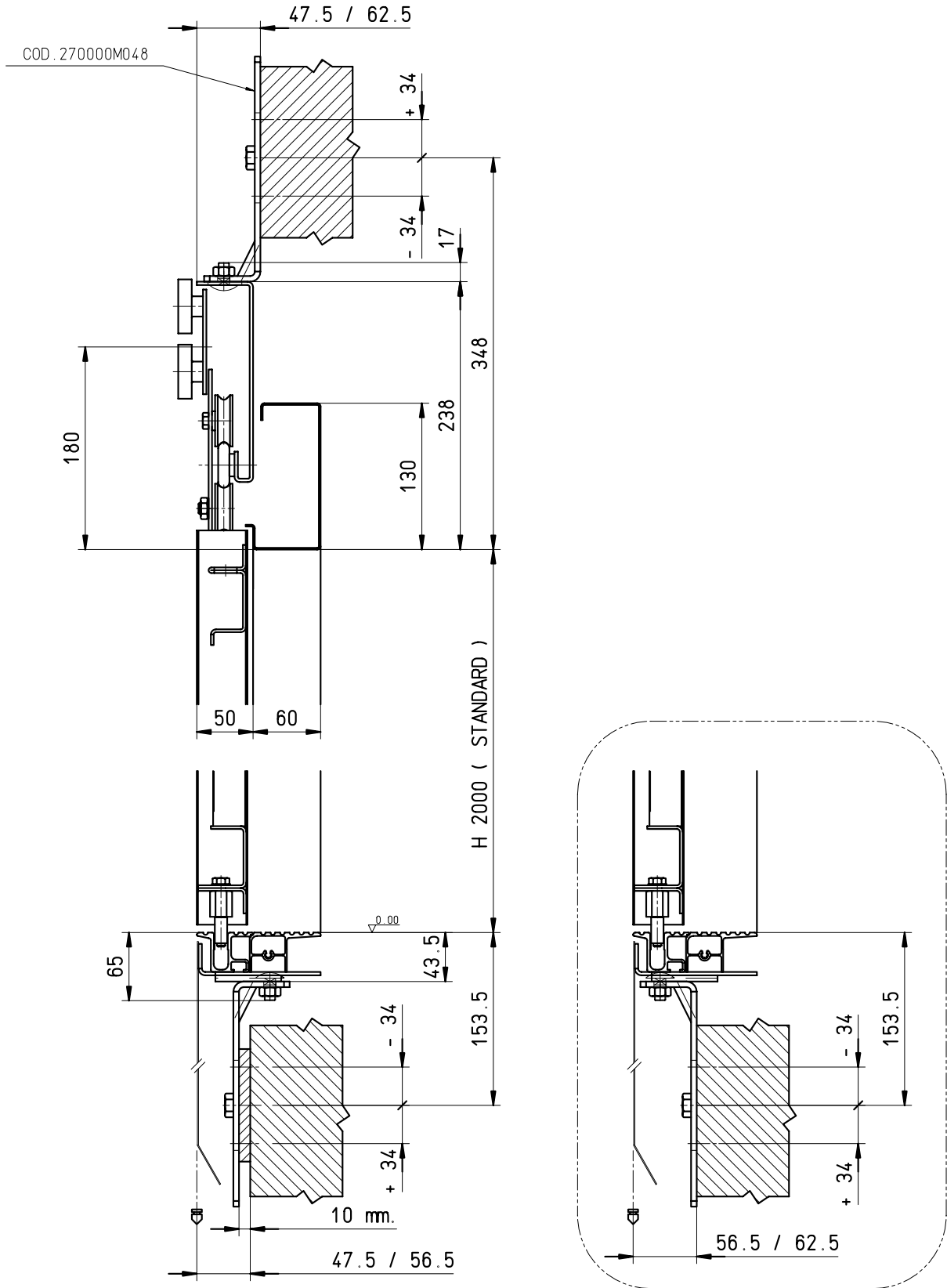

Serie "Q" DIN 18091

FIXING WITH UNI STRUTS

01_06_00_01REV00

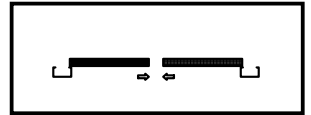

L2C

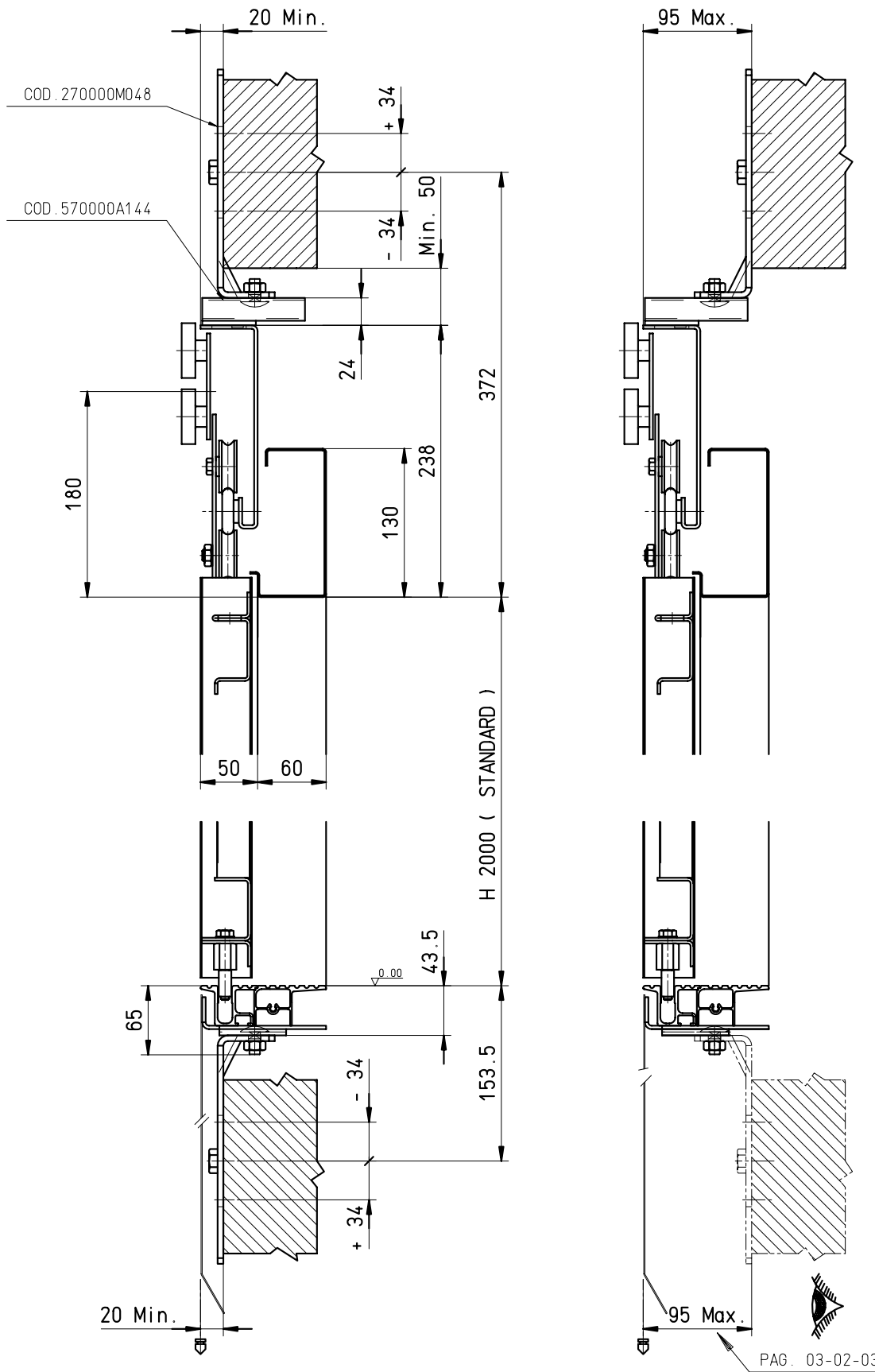

**L2S /R-L
SMALL**

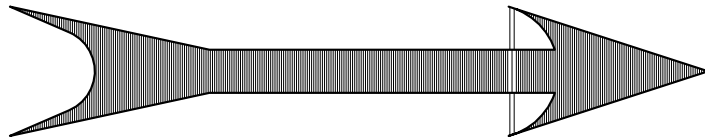

Serie "Q" DIN 18091 SMALL

STANDARD

01_06_00_01REV00

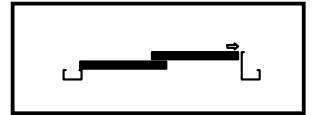

L2S/...

A 500 - 550

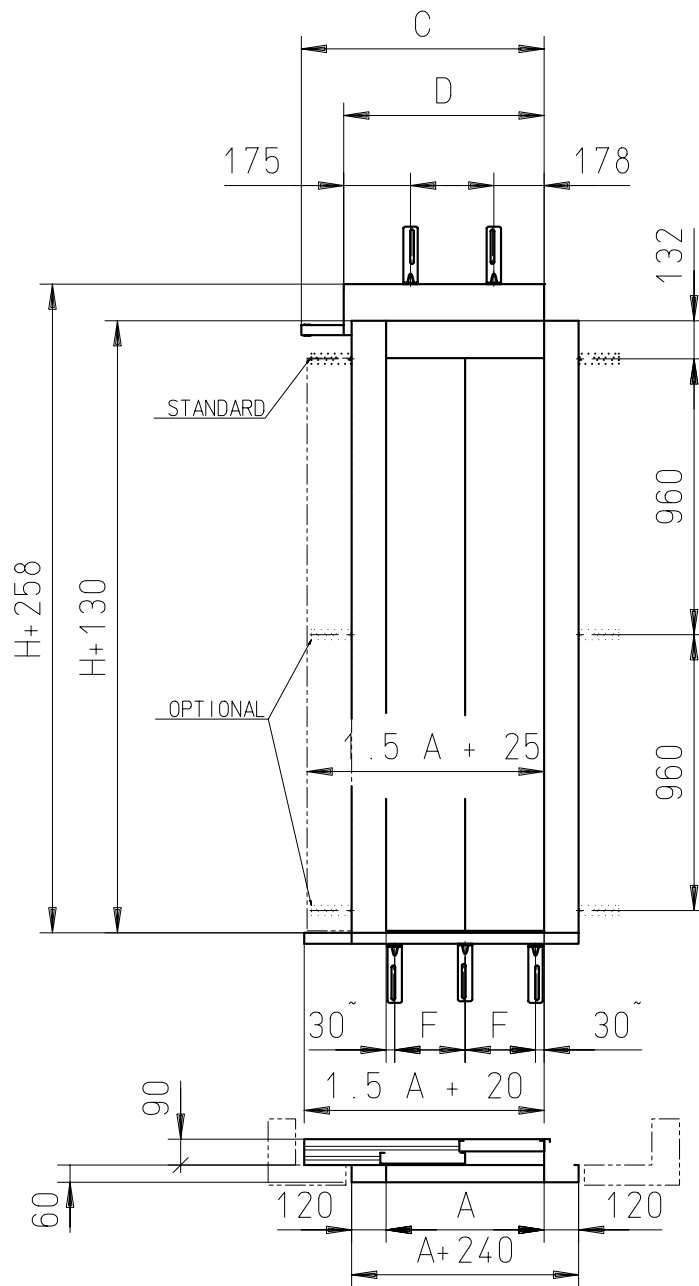

SMALL

A	500	550
C	794	844
D	773	773
F	220	245
	NR. 3	

Serie "Q" DIN 18091 SMALL

FIXING STANDARD

01_06_00_01REV00

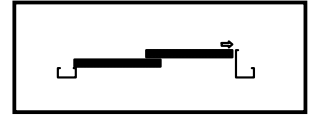

L2S/...

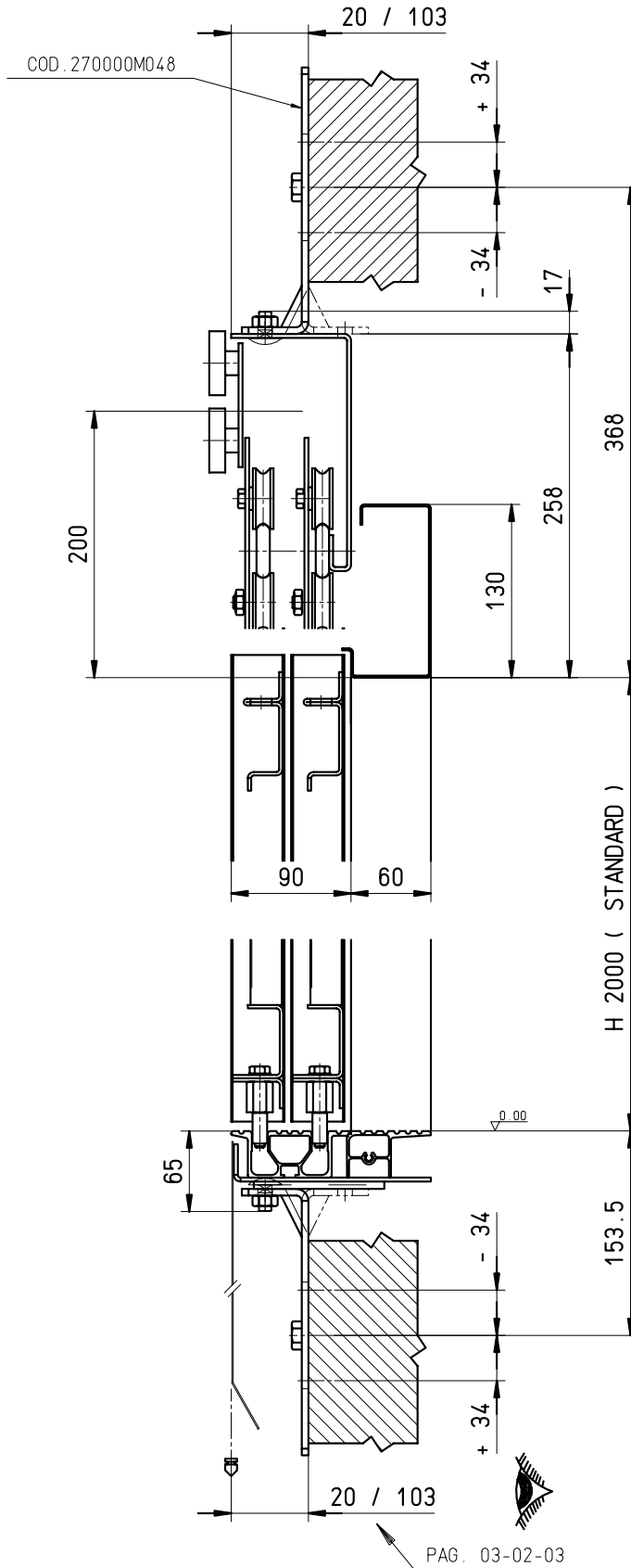

SMALL

Serie "Q" DIN 18091 SMALL

FIXING WITH UNI STRUTS

01_06_00_01REV00

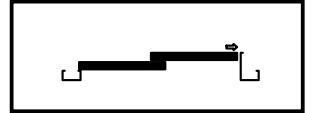

L2S/...

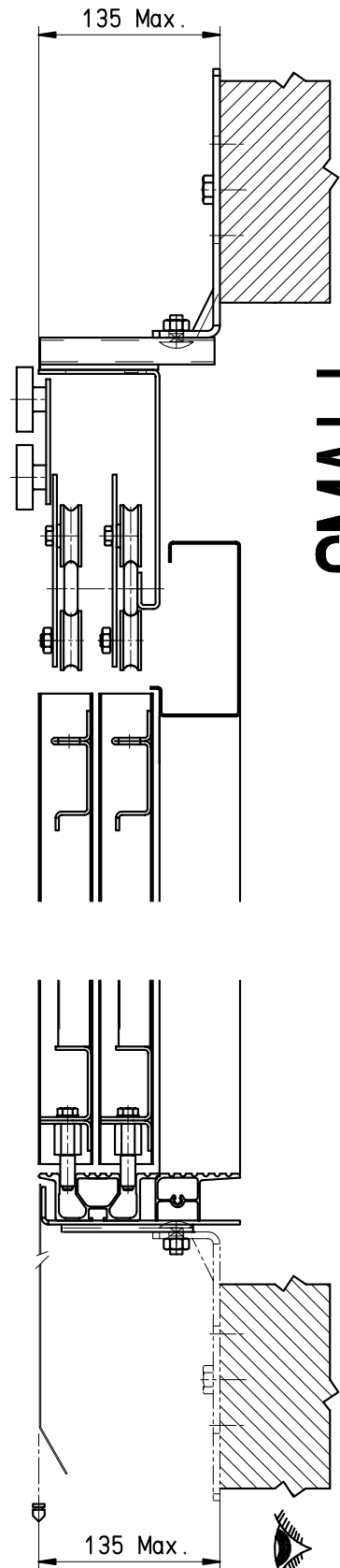
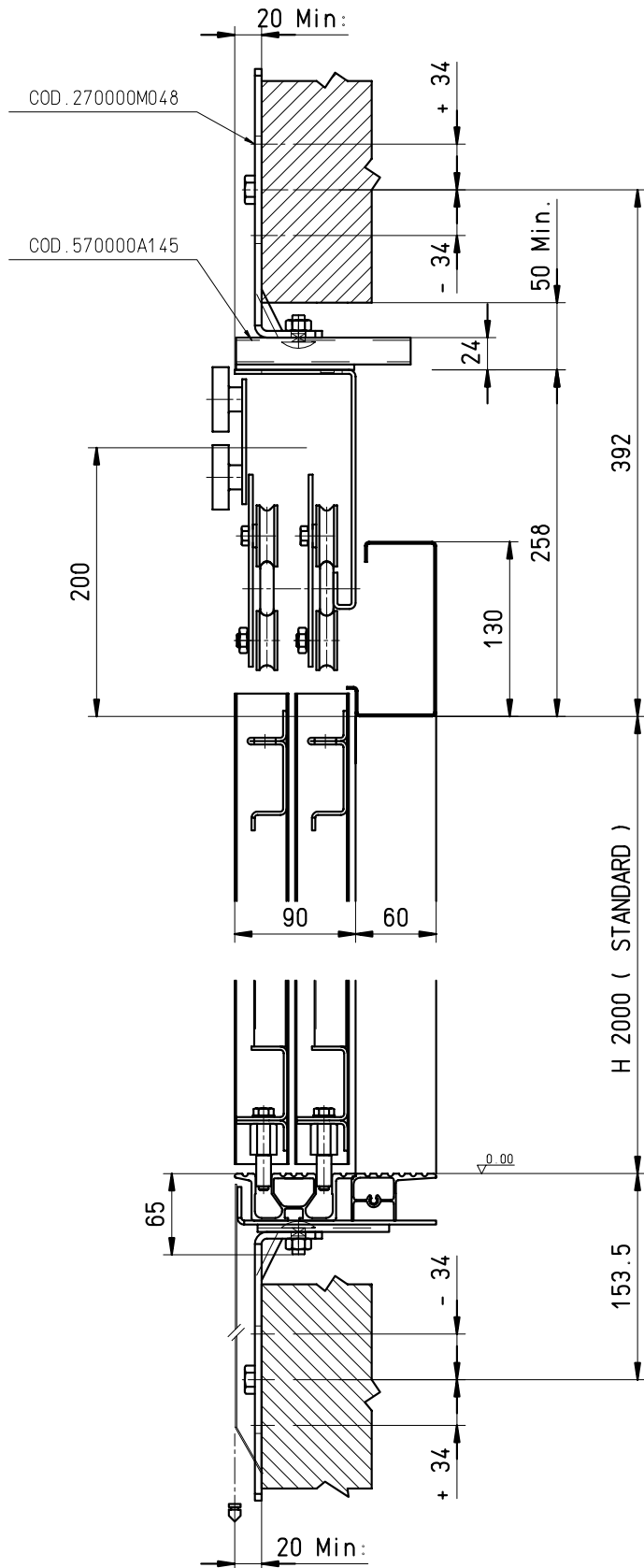

SMALL

PAG. 03-02-03

L2S /R-L

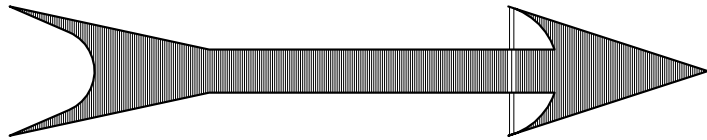

Serie "Q" DIN 18091

STANDARD

01_06_00_01REV00

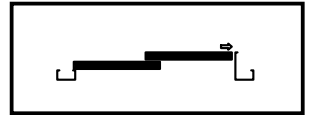

L2S/...

A 600 - 2000

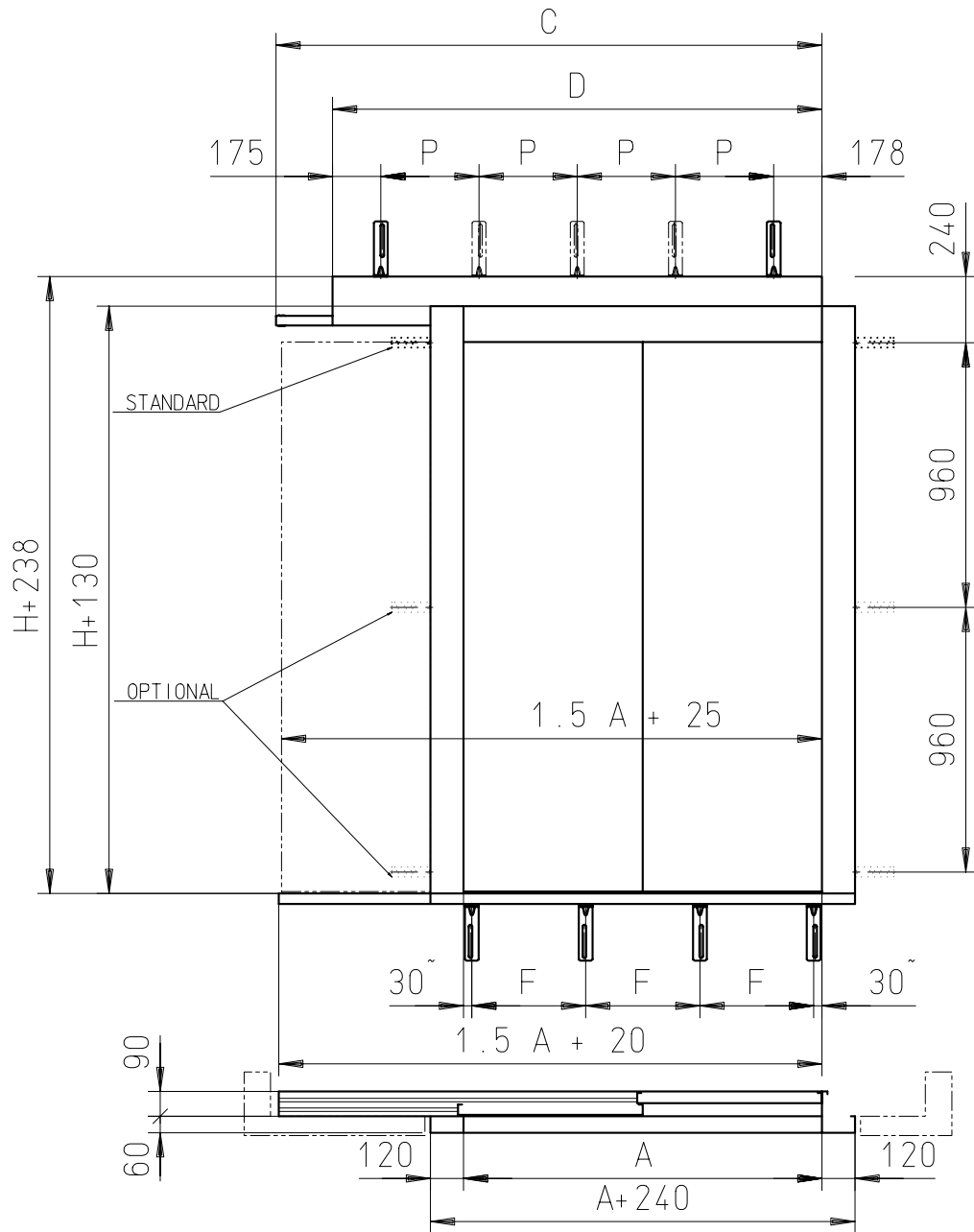

A	600	650	700	750	800	850	900	950	1000	1050	1100	1150	1200	1250	1300	1350	1400	1450	1500	1550	1600	1650	1700	1750	1800	1850	1900	1950	2000	
C	944	994	1086	1136	1239	1289	1389	1439	1539	1589	1689	1739	1839	1889	1989	2039	2139	2189	2289	2339	2439	2489	2589	2639	2739	2789	2889	2939	3039	
D	748	940	940	940	940	1235	1235	1235	1235	1535	1535	1535	1535	1835	1835	1835	1835	2135	2135	2135	2135	2435	2435	2435	2435	2735	2735	2735	2735	
F	270	295	320	345	370	395	420	445	313	330	346	363	380	396	413	430	447	347	360	372	385	397	410	422	435	447	368	378	388	
	NR. 3								NR. 4								NR. 5								NR. 6					
P	0	293.5	293.5	293.5	293.5	441	441	441	441	591	591	591	591	591	370.5	370.5	370.5	370.5	445.5	445.5	445.5	445.5	520.5	520.5	520.5	520.5	595.5	595.5	595.5	595.5
	NR. 2		NR. 3								NR. 4								NR. 5											

Serie "Q" DIN 18091

FIXING STANDARD

01_06_00_01REV00

L2S/...

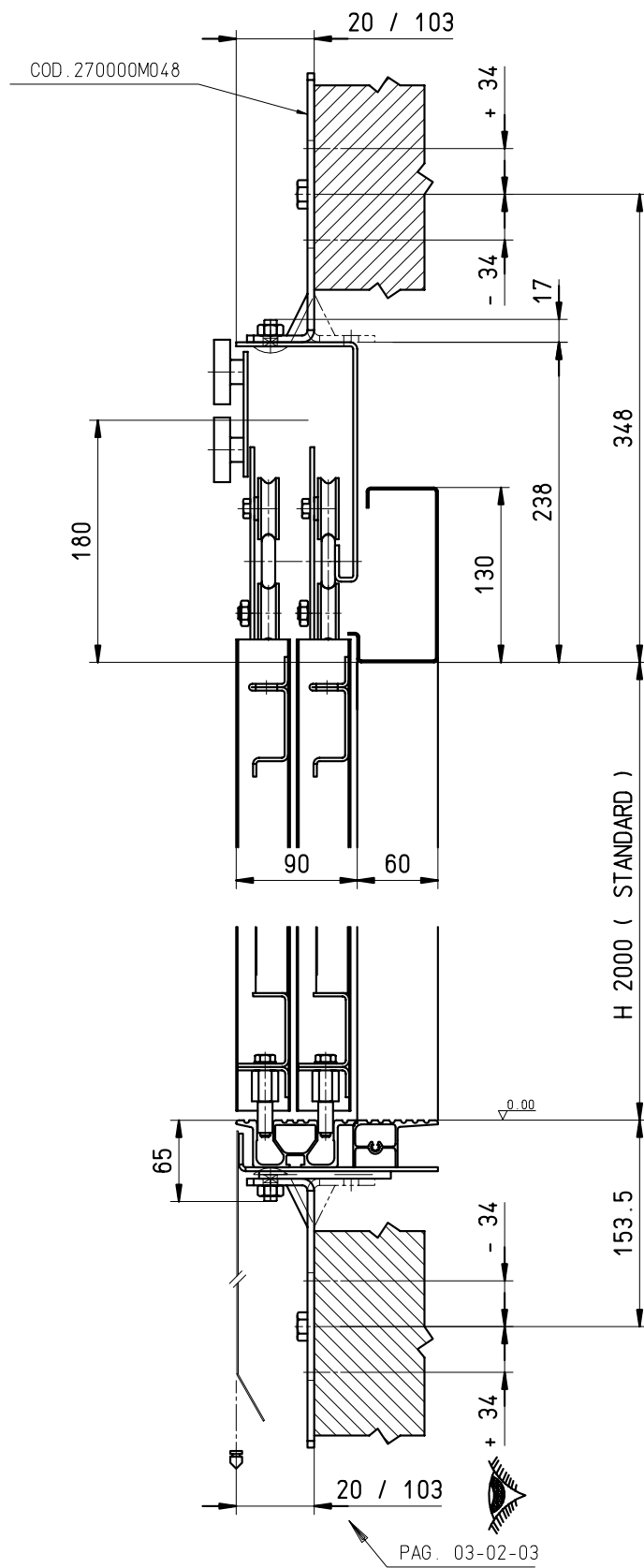

Serie "Q" DIN 18091

FIXING WITH UNI STRUTS

01_06_00_01REV00

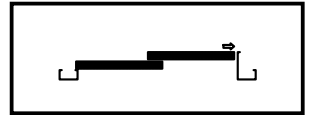

L2S/...

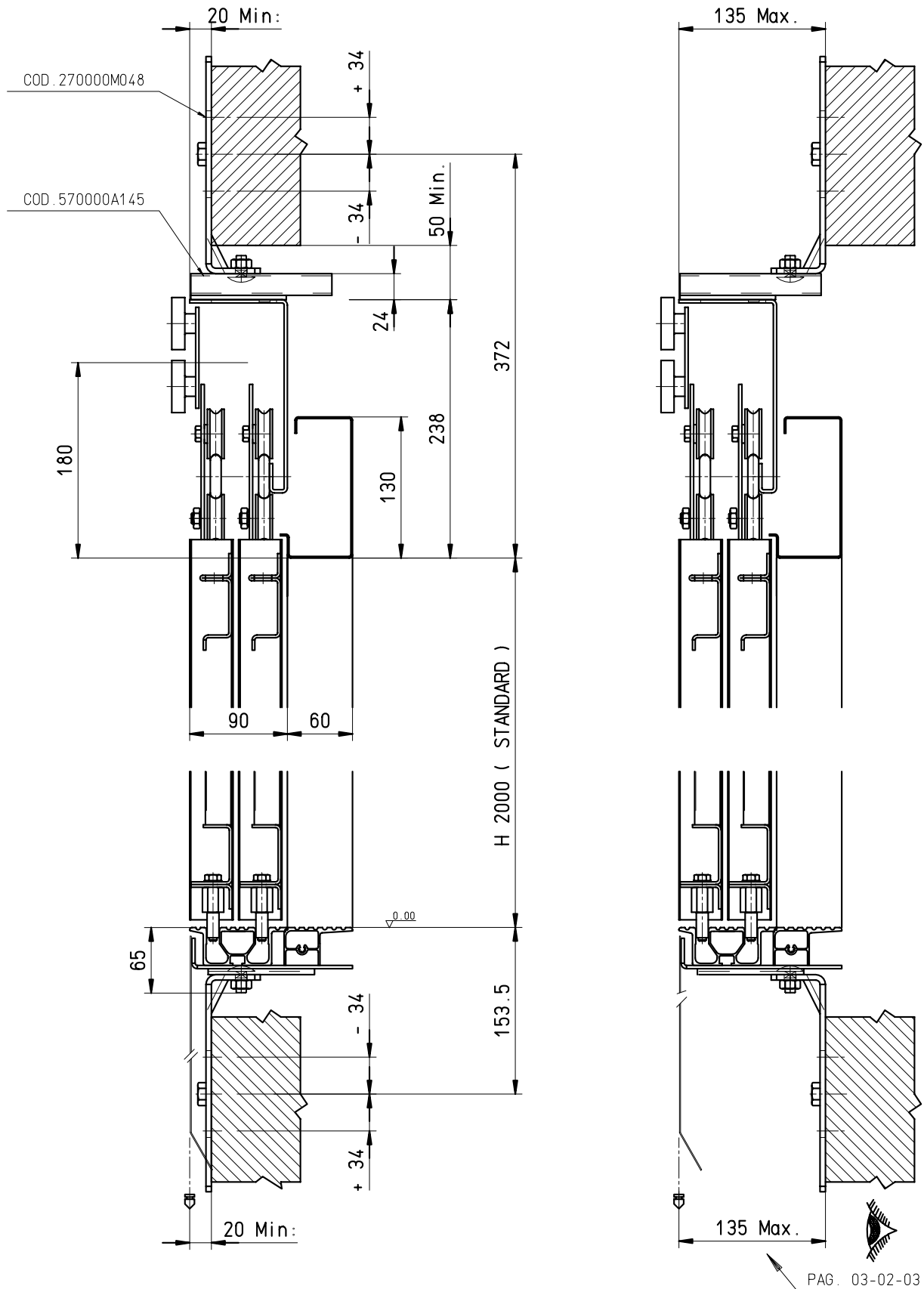

**L4C
SMALL**

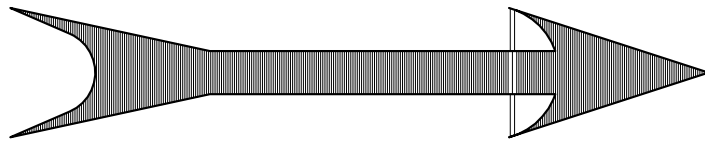

Serie "Q" DIN 18091 SMALL

STANDARD

01_06_00_01REV00

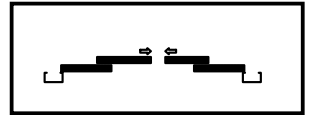

L4C

A 650 - 1150

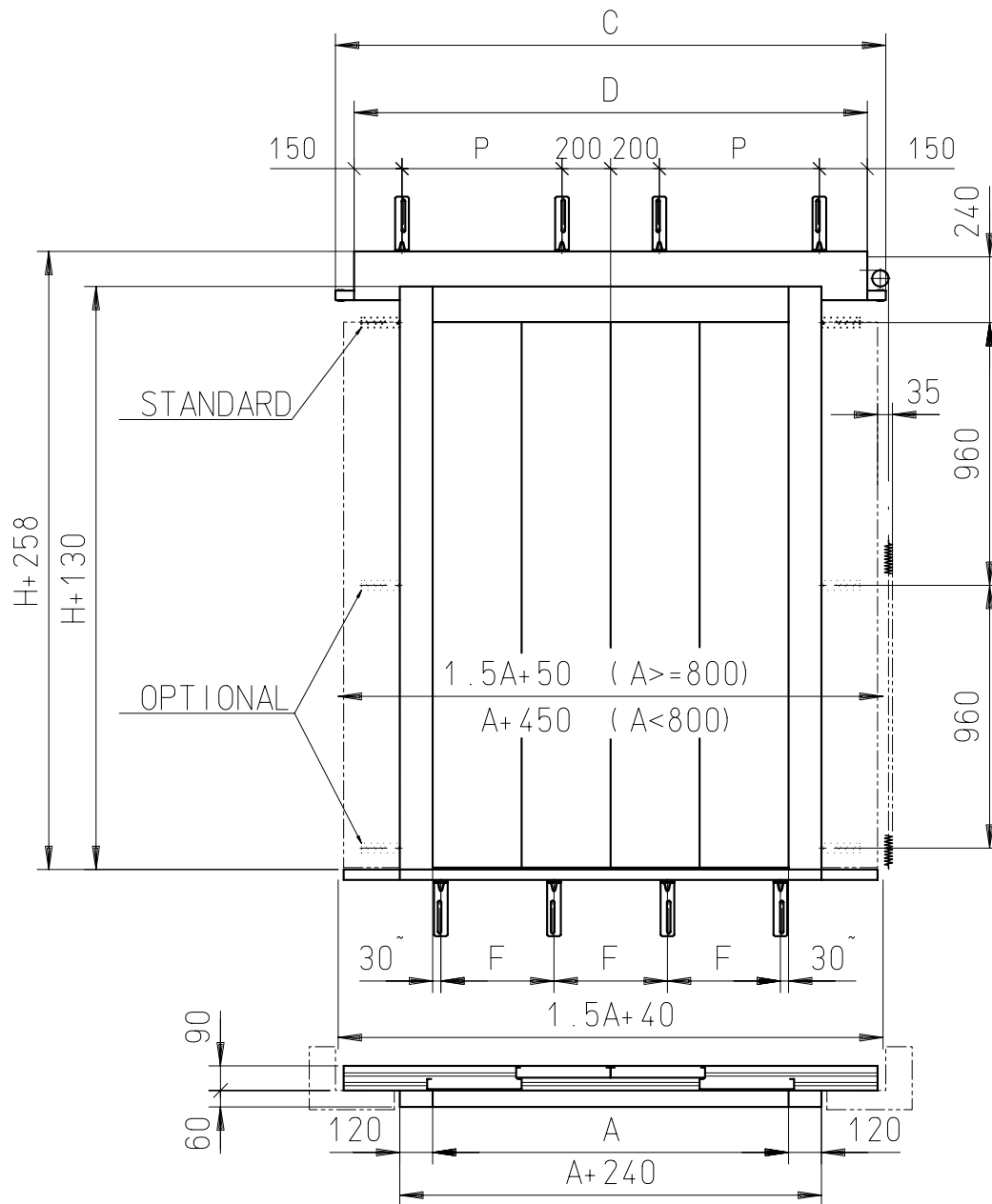

SMALL

A	650	700	750	800	850	900	950	1000	1050	1100	1150
C	1138	1188	1238	1288	1338	1438	1488	1588	1638	1688	1738
D	1030	1030	1030	1030	1030	1330	1330	1330	1330	1330	1330
F	295	320	345	370	395	420	445	313	330	346	363
	NR. 3						NR. 4				
P	165	165	165	165	165	315	315	315	315	315	315
	NR. 4										

Serie "Q" DIN 18091 SMALL

FIXING STANDARD

01_06_00_01REV00

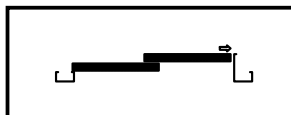

L2S/...



L4C

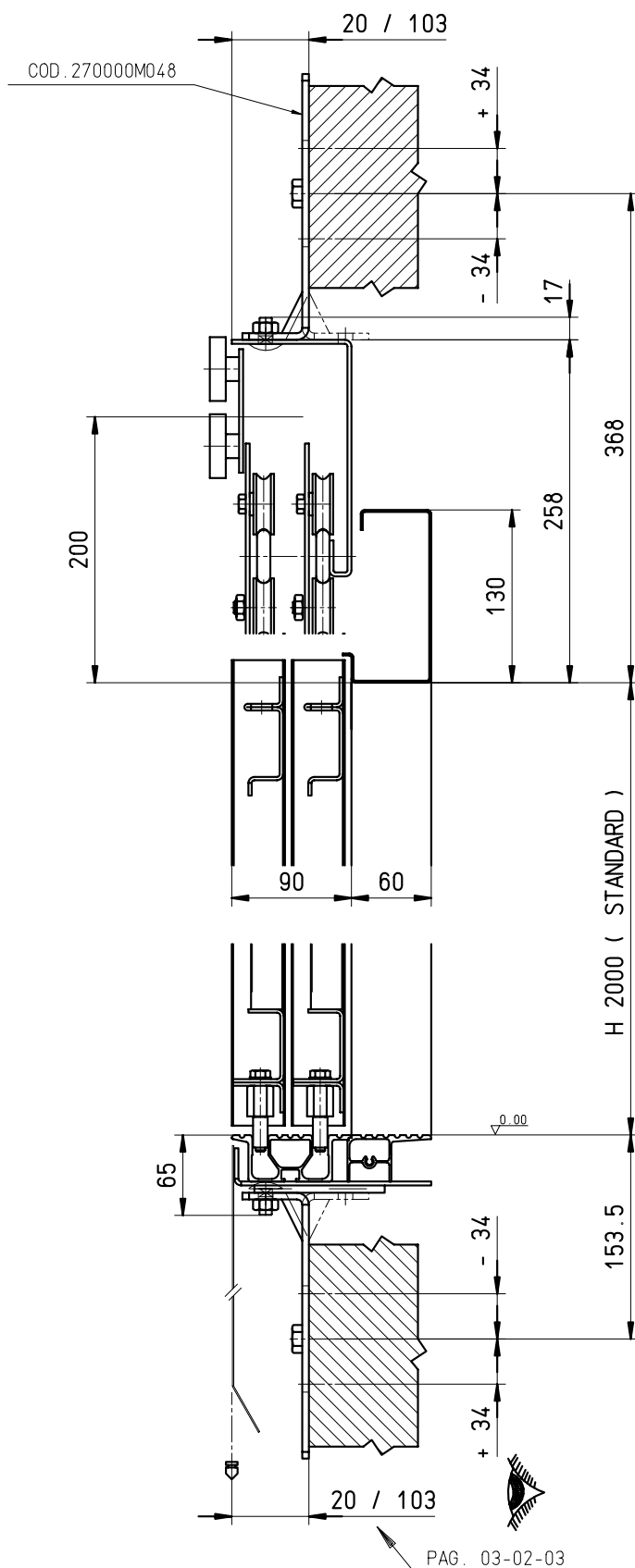

SMALL

Serie "Q" DIN 18091 SMALL

FIXING WITH UNI STRUTS

01_06_00_01REV00

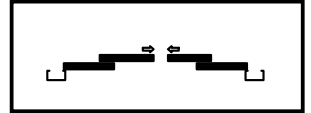

L4C

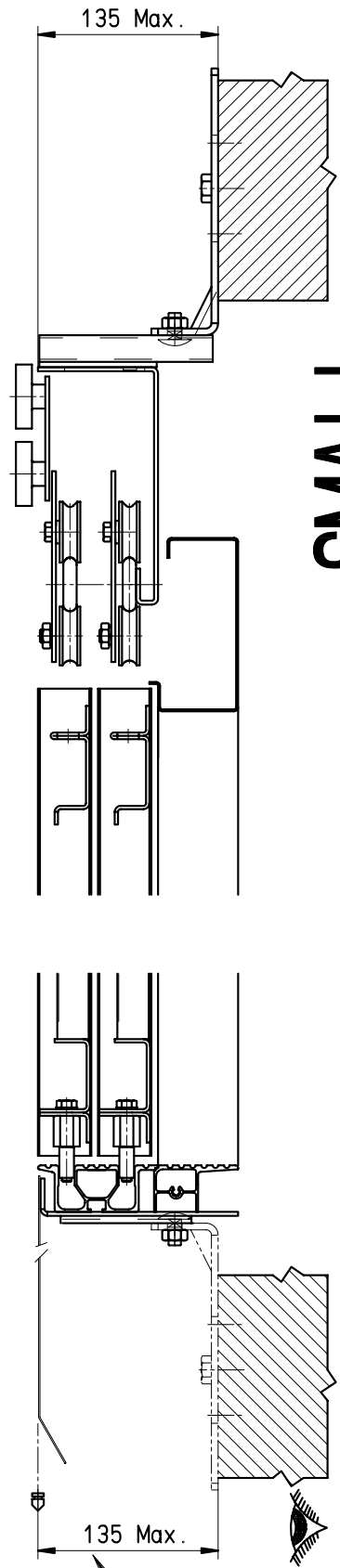
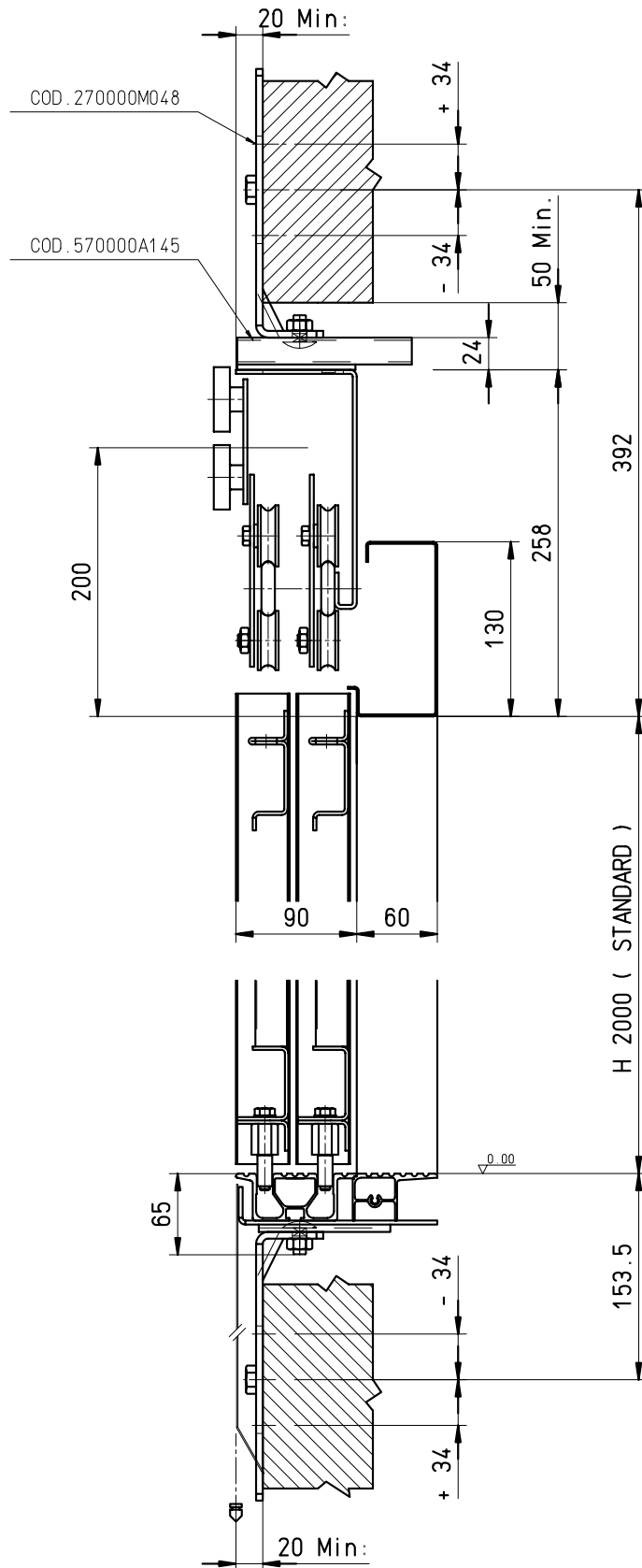

SMALL

PAG. 03-02-03

L4C

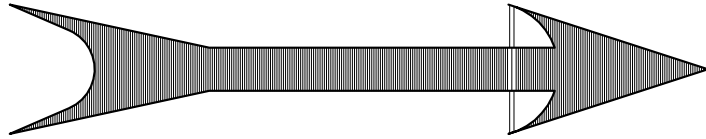

Serie "Q" DIN 18091

STANDARD

01_06_00_01REV00

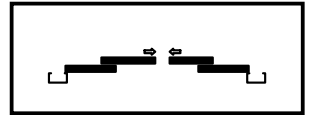

L4C

A 1200 - 4000

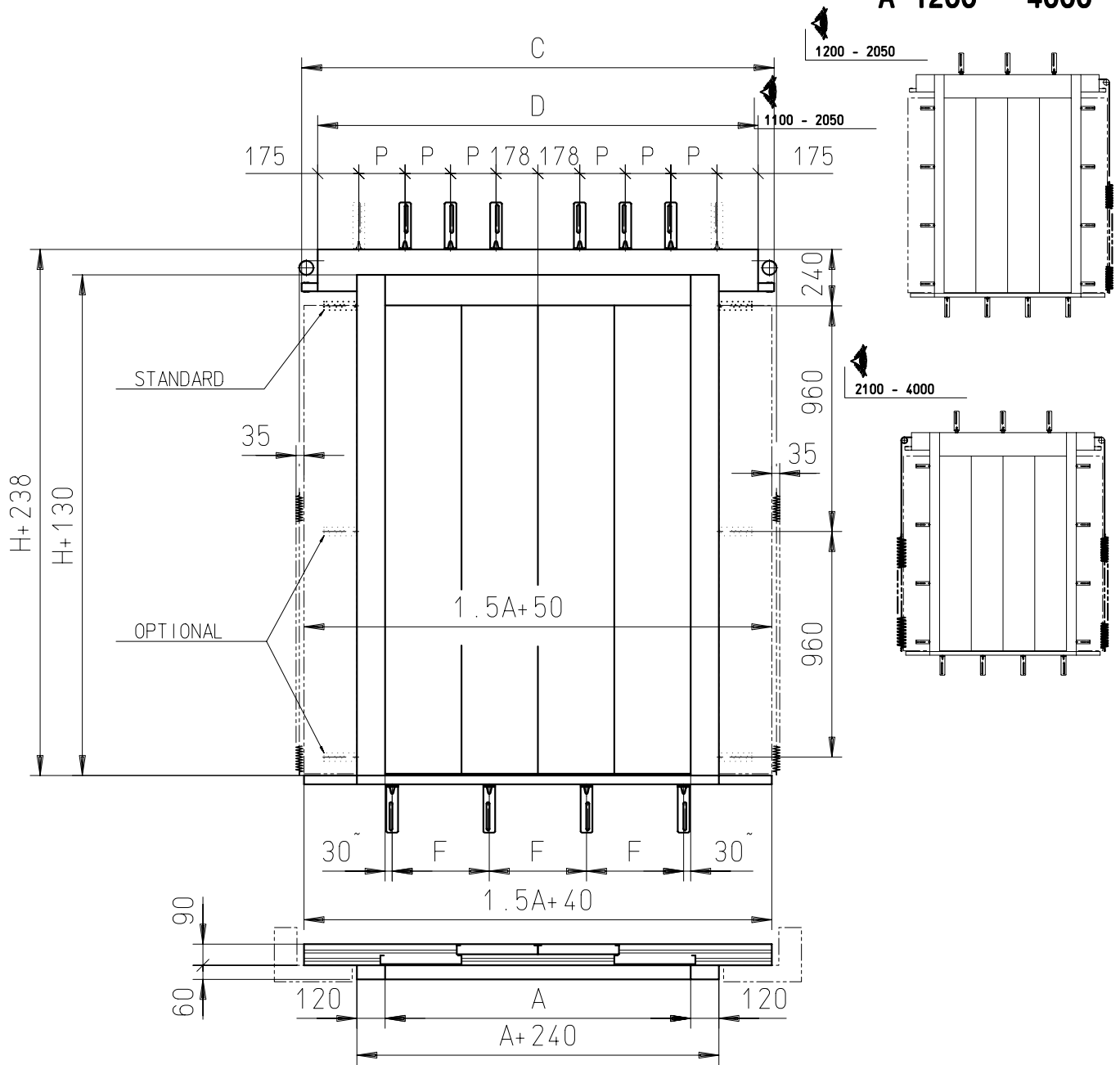

A	1200	1250	1300	1350	1400	1450	1500	1600	1700	1800	1900	2000	2100	2200	2300	2400	2500	2600	2700	2800	2900	3000	3100	3200	3300	3400	3500	3600	3700	3800	3900	4000
C	1888	1938	1988	2038	2172	2222	2272	2478	2578	2778	2878	3078	3178	3378	3478	3678	3778	3978	4078	4278	4378	4578	4678	4878	4978	5178	5278	5478	5578	5778	5878	6078
D	1496	1496	1880	1880	1880	1880	1880	2470	2470	2470	2470	2470	3070	3070	3070	3070	3670	3670	3670	3670	4270	4270	4270	4270	4870	4870	4870	5470	5470	5470	5470	
F	380	396	413	430	447	347	360	385	410	435	368	388	408	428	448	390	406	423	440	391	405	420	434	448	462	477	491	505	520	534	548	562
	NR. 4				NR. 5				NR. 6				NR. 7				NR. 8															
P	395	395	293.5	293.5	293.5	293.5	293.5	293.5	441	441	441	441	591	591	591	591	370.5	370.5	370.5	370.5	445.5	445.5	445.5	445.5	520.5	520.5	520.5	520.5	595.5	595.5	595.5	595.5
	NR. 2		NR. 4				NR. 6				NR. 10																					

Serie "Q" DIN 18091

FIXING STANDARD

01_06_00_01REV00

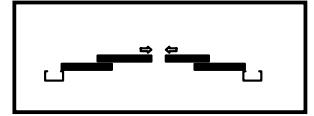

L4C

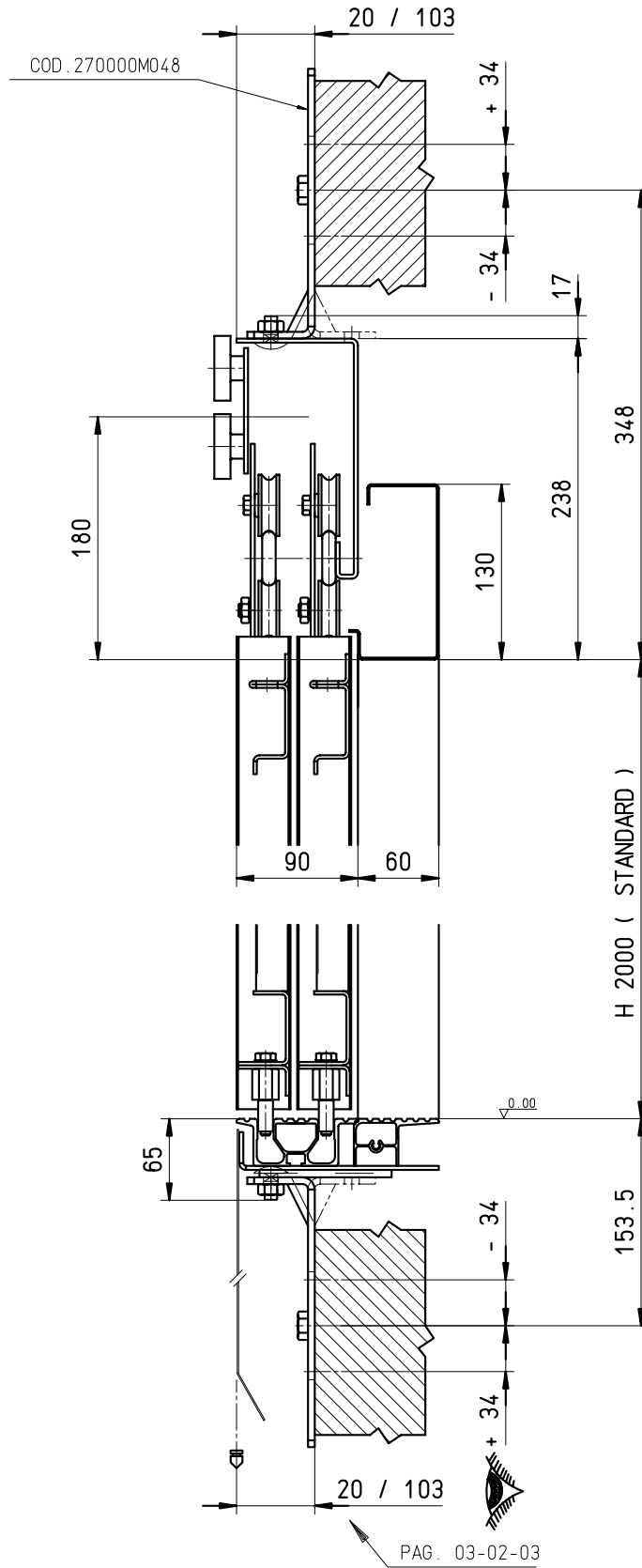

Serie "Q" DIN 18091

FIXING WITH UNI STRUTS

01_06_00_01REV00



L4C

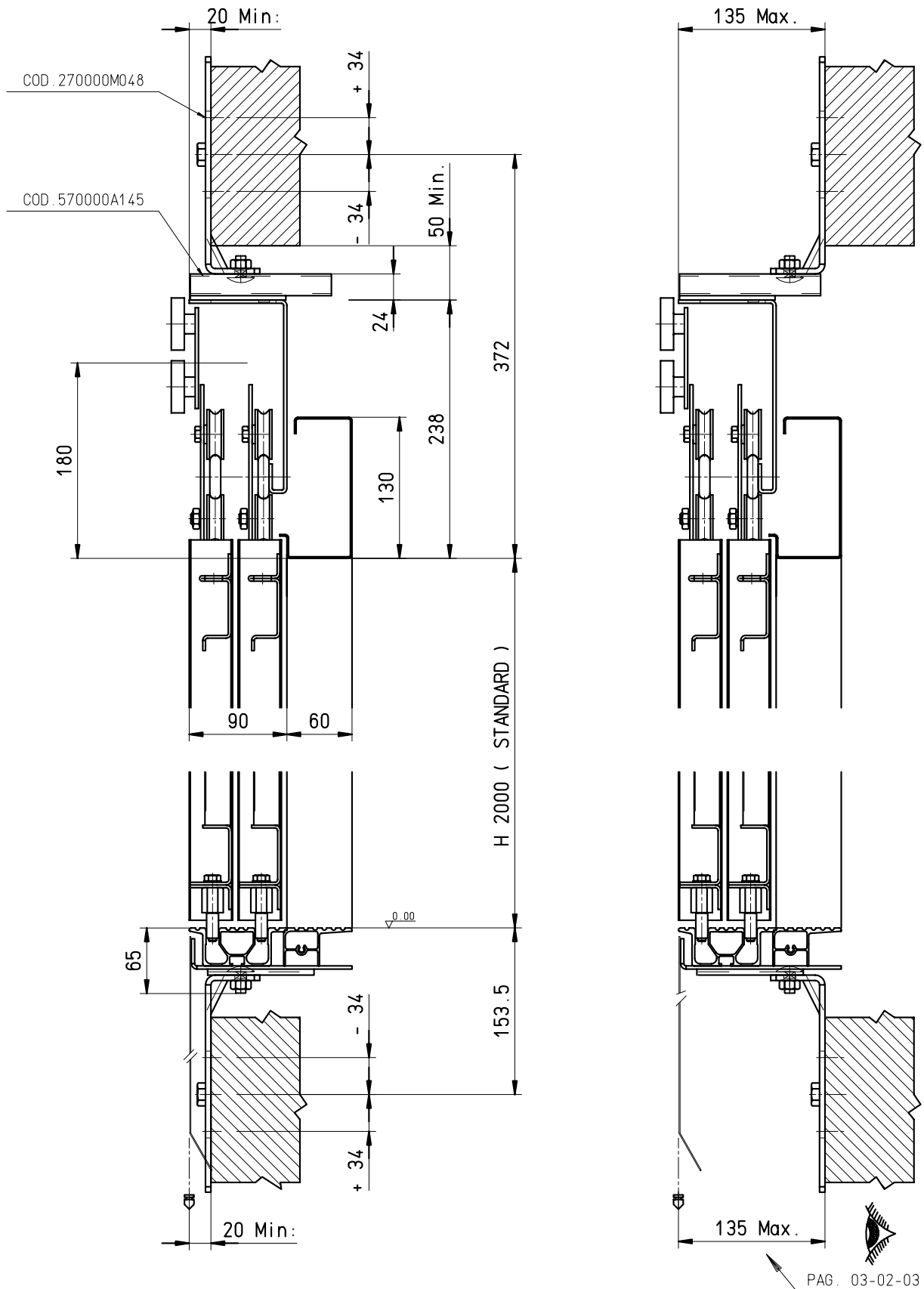

L3S /R-L
SMALL

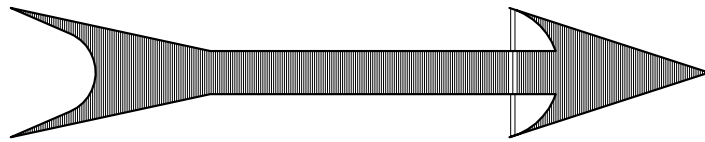

Serie "Q" DIN 18091 SMALL

STANDARD

01_06_00_01REV00

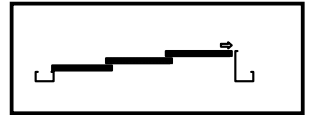

L3S/...

A 500 - 850

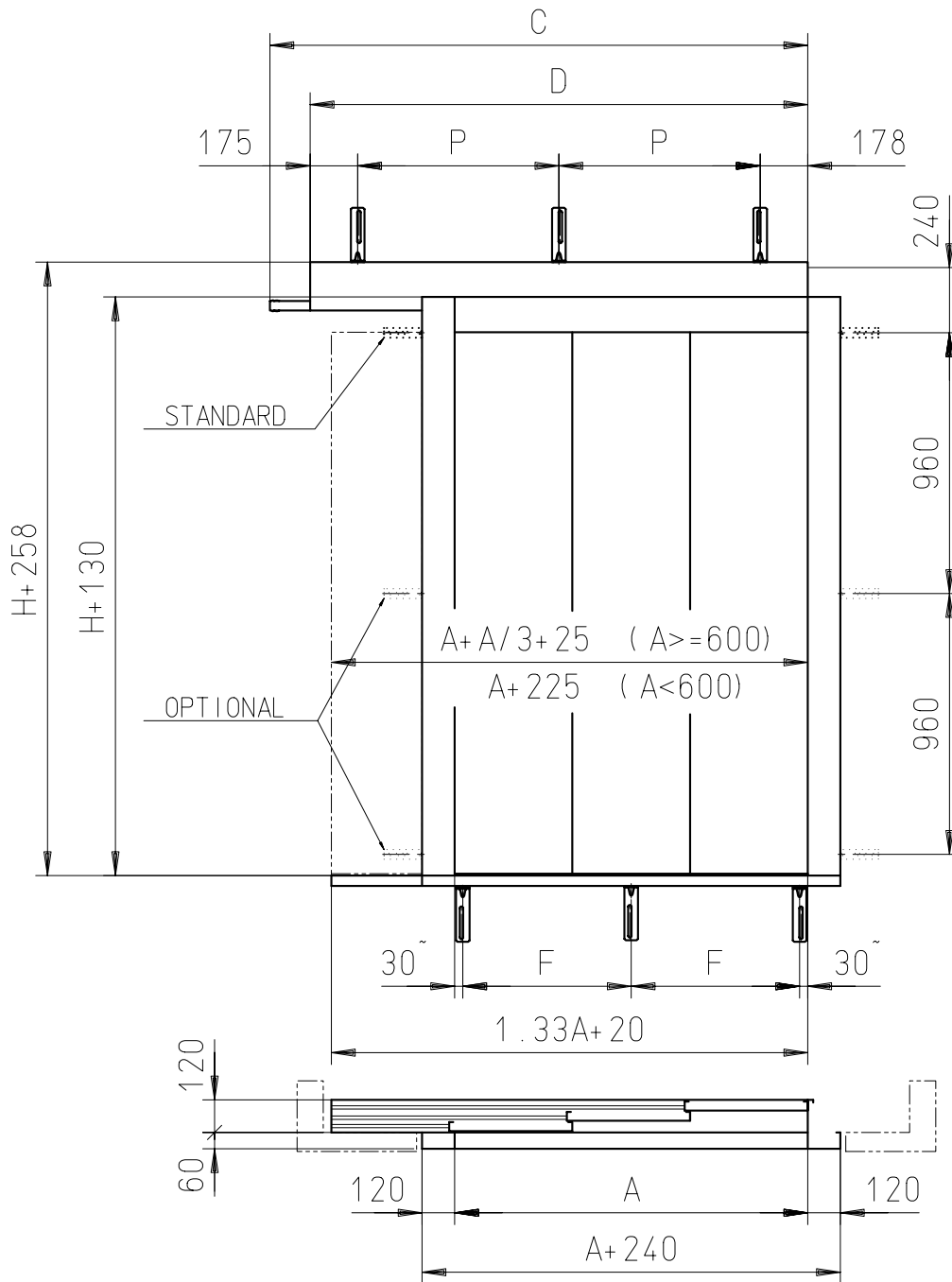

SMALL

A	500	550	600	650	700	750	800	850
C	744	794	844	894	969	1019	1094	1144
D	715	715	815	815	815	990	990	990
F	220	245	270	295	320	345	370	395
	NR. 3							
P	0	0	0	0	0	333.5	333.5	333.5
	NR. 2					NR. 3		

Serie "Q" DIN 18091 SMALL

FIXING STANDARD

01_06_00_01REV00

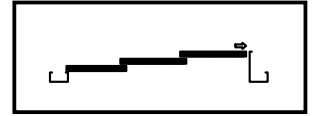

L3S/...

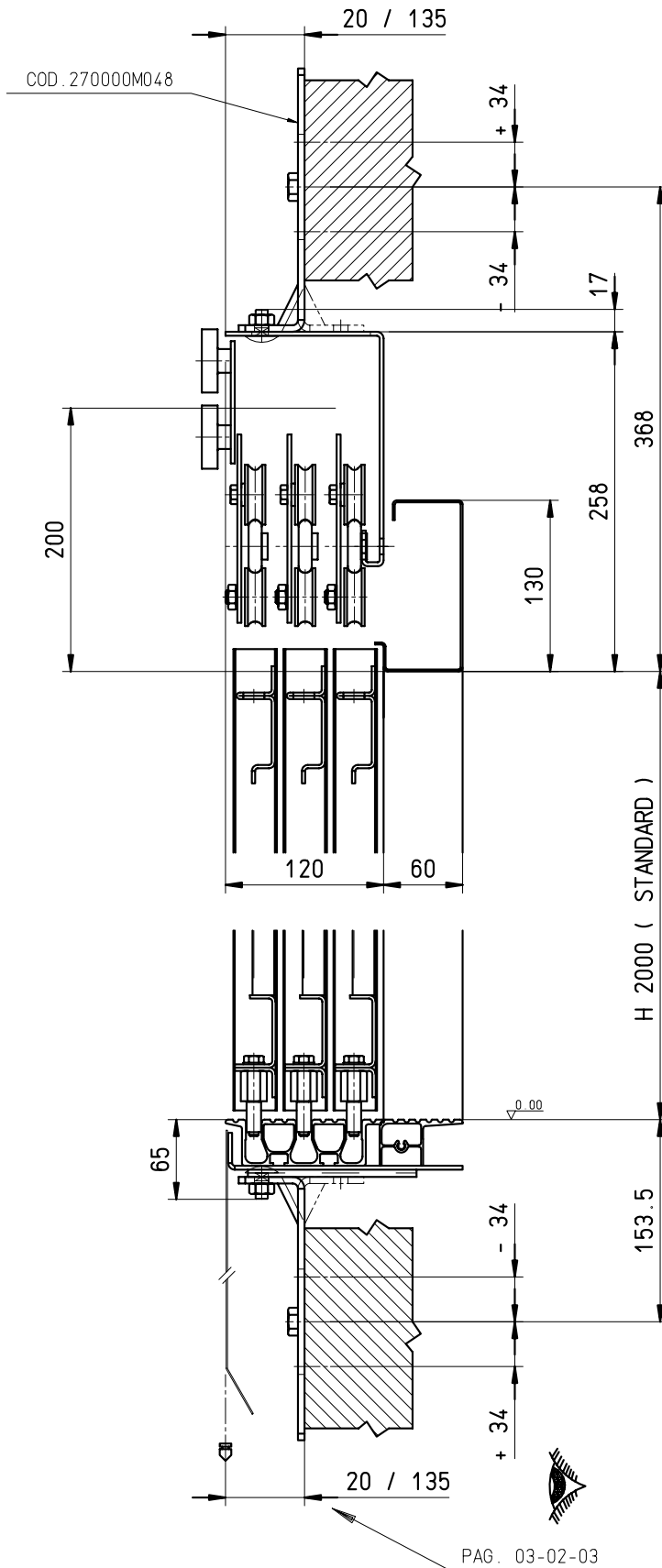

SMALL

Serie "Q" DIN 18091 SMALL

FIXING WITH UNI STRUTS

01_06_00_01REV00

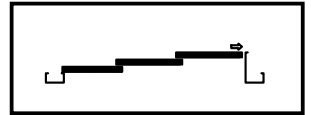

L3S/...

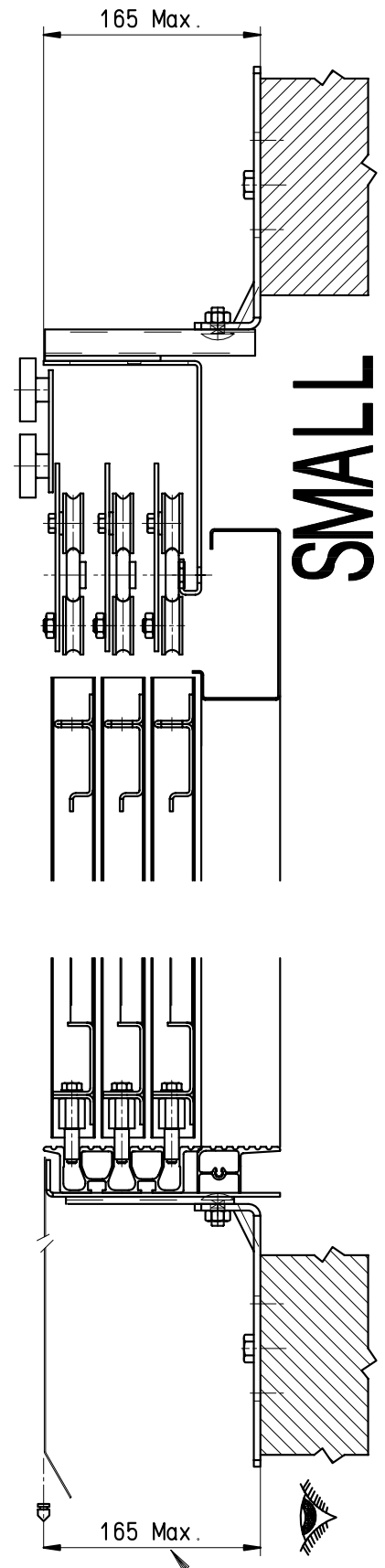
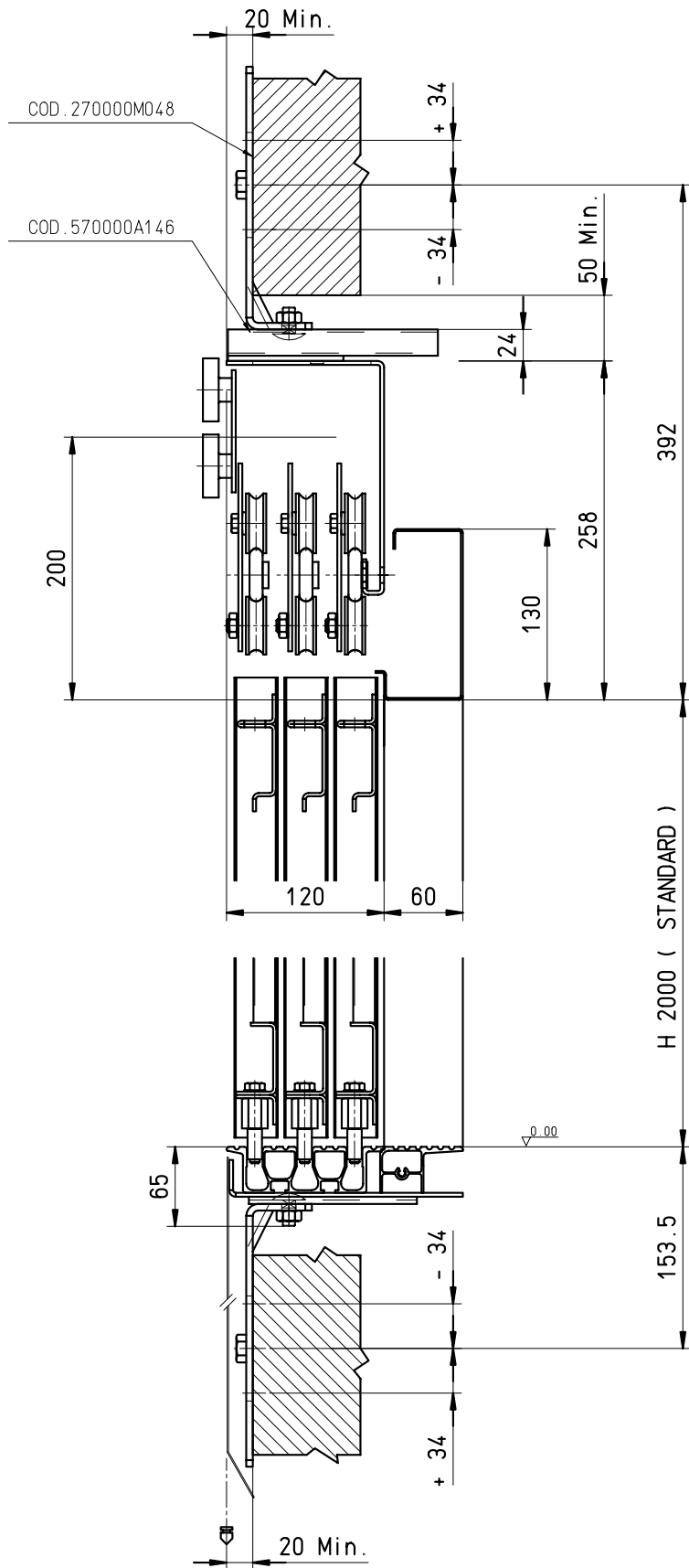

PAG. 03-02-03

L3S /R-L

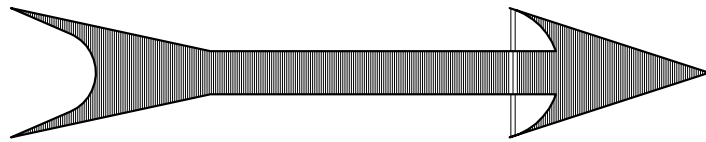

Serie "Q" DIN 18091

STANDARD

01_06_00_01REV00

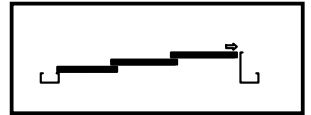

L3S/...

A 900 - 2000

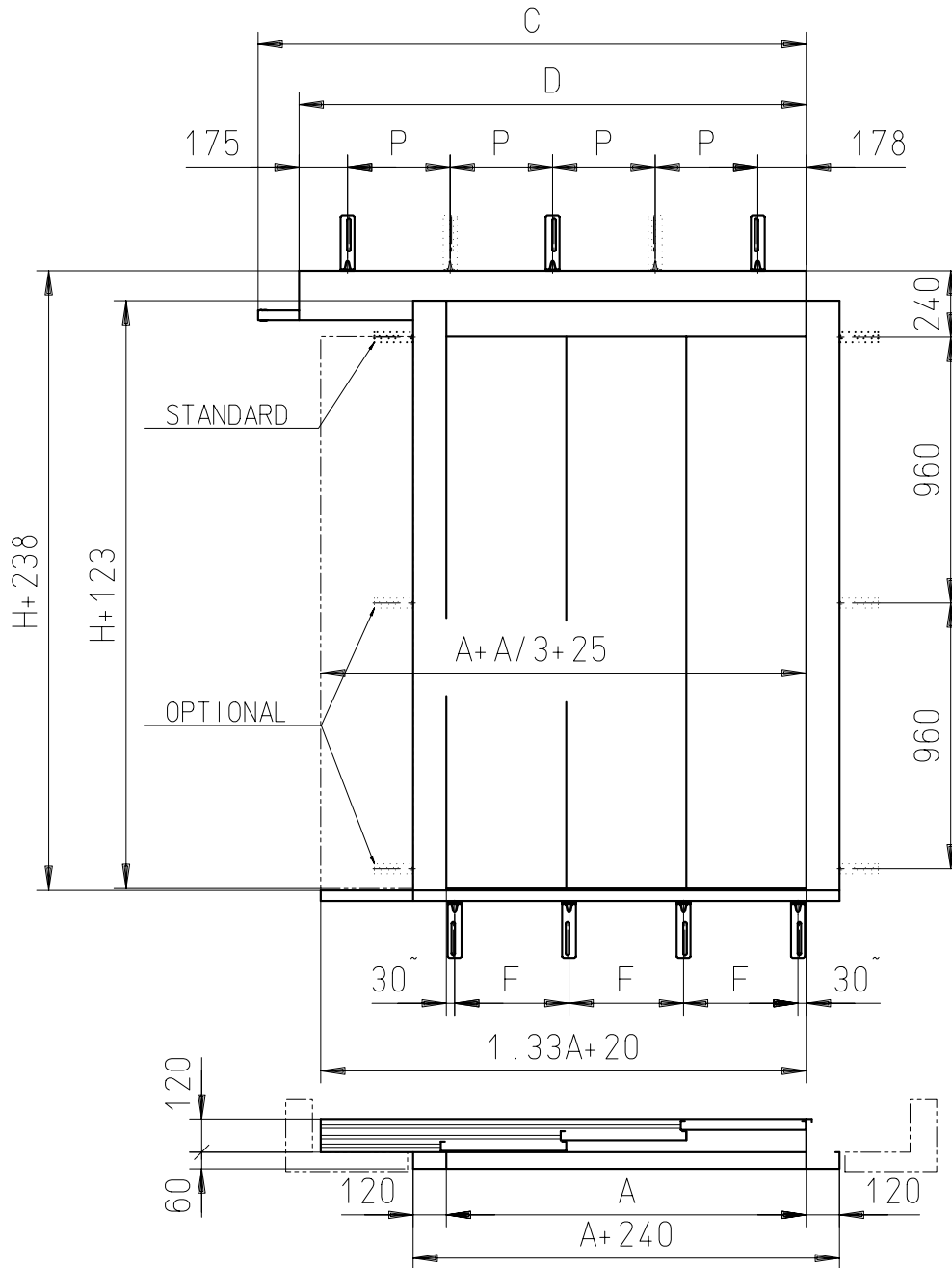

A	900	950	1000	1050	1100	1150	1200	1250	1300	1350	1400	1450	1500	1550	1600	1650	1700	1750	1800	1850	1900	1950	2000
C	1244	1294	1344	1436	1486	1536	1639	1689	1739	1839	1889	1939	2039	2089	2139	2239	2289	2339	2439	2489	2539	2639	2689
D	1212	1212	1212	1404	1404	1404	1596	1596	1596	1788	1788	1788	1980	1980	1980	2172	2172	2172	2364	2364	2364	2556	2556
F	420	445	313	330	346	363	380	396	413	430	447	347	360	372	385	397	410	422	435	447	368	378	388
	NR. 3		NR. 4					NR. 5					NR. 6										
P	429.5	429.5	429.5	525.5	525.5	525.5	311	311	311	359	359	359	407	407	407	455	455	455	503	503	503	551	551
	NR. 3					NR. 5																	

Serie "Q" DIN 18091

FIXING STANDARD

01_06_00_01REV00

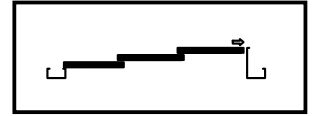

L3S/...

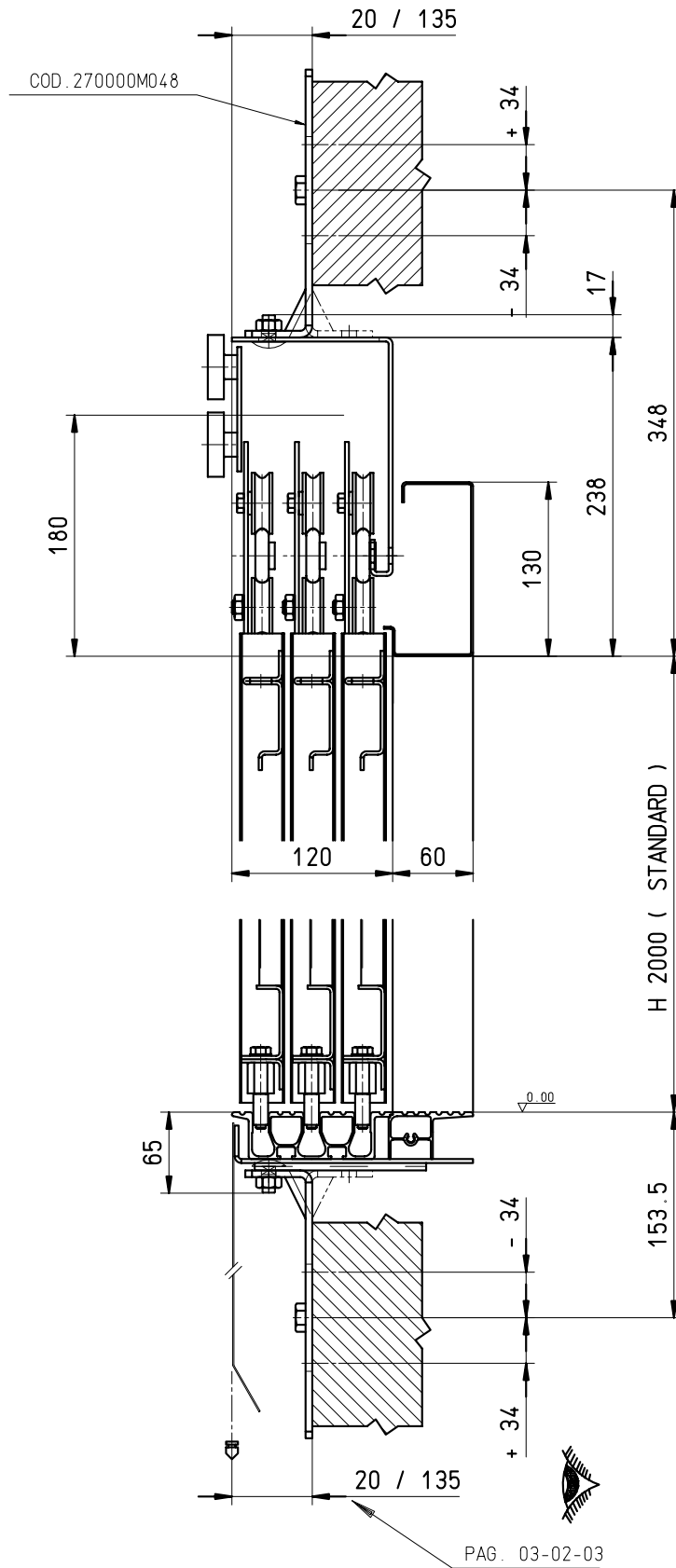

Serie "Q" DIN 18091

FIXING WITH UNI STRUTS

01_06_00_01REV00

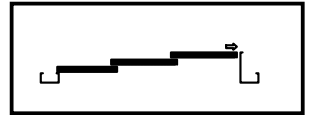

L3S/...

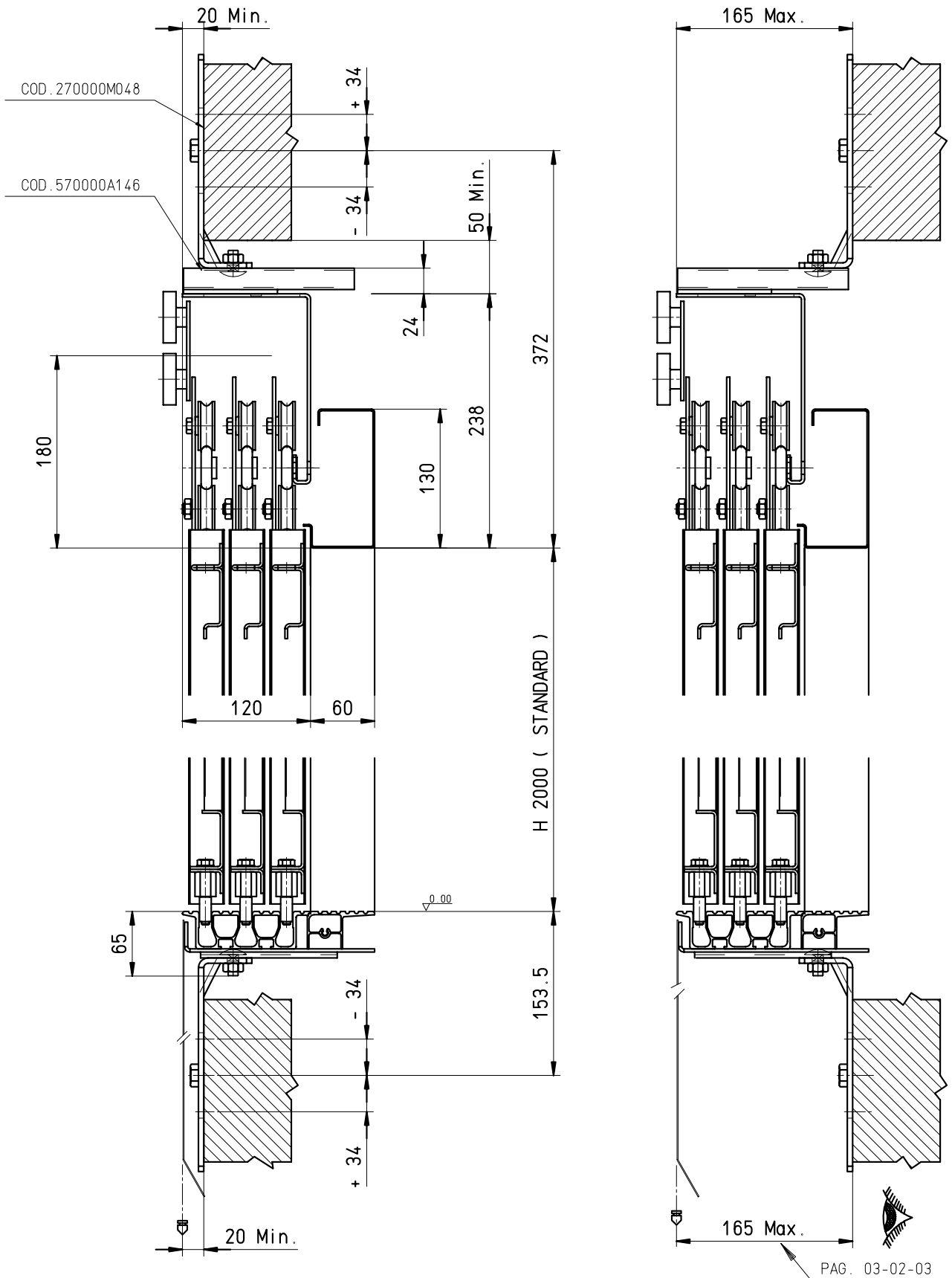

**L6C
SMALL**

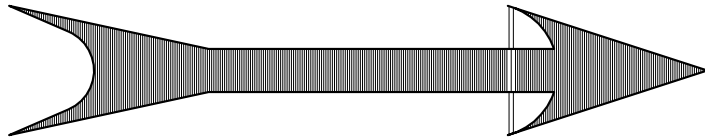

Serie "Q" DIN 18091 SMALL

STANDARD

01_06_00_01REV00

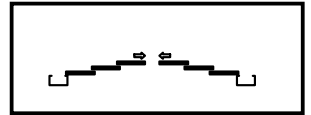

L6C

A 900 - 1750

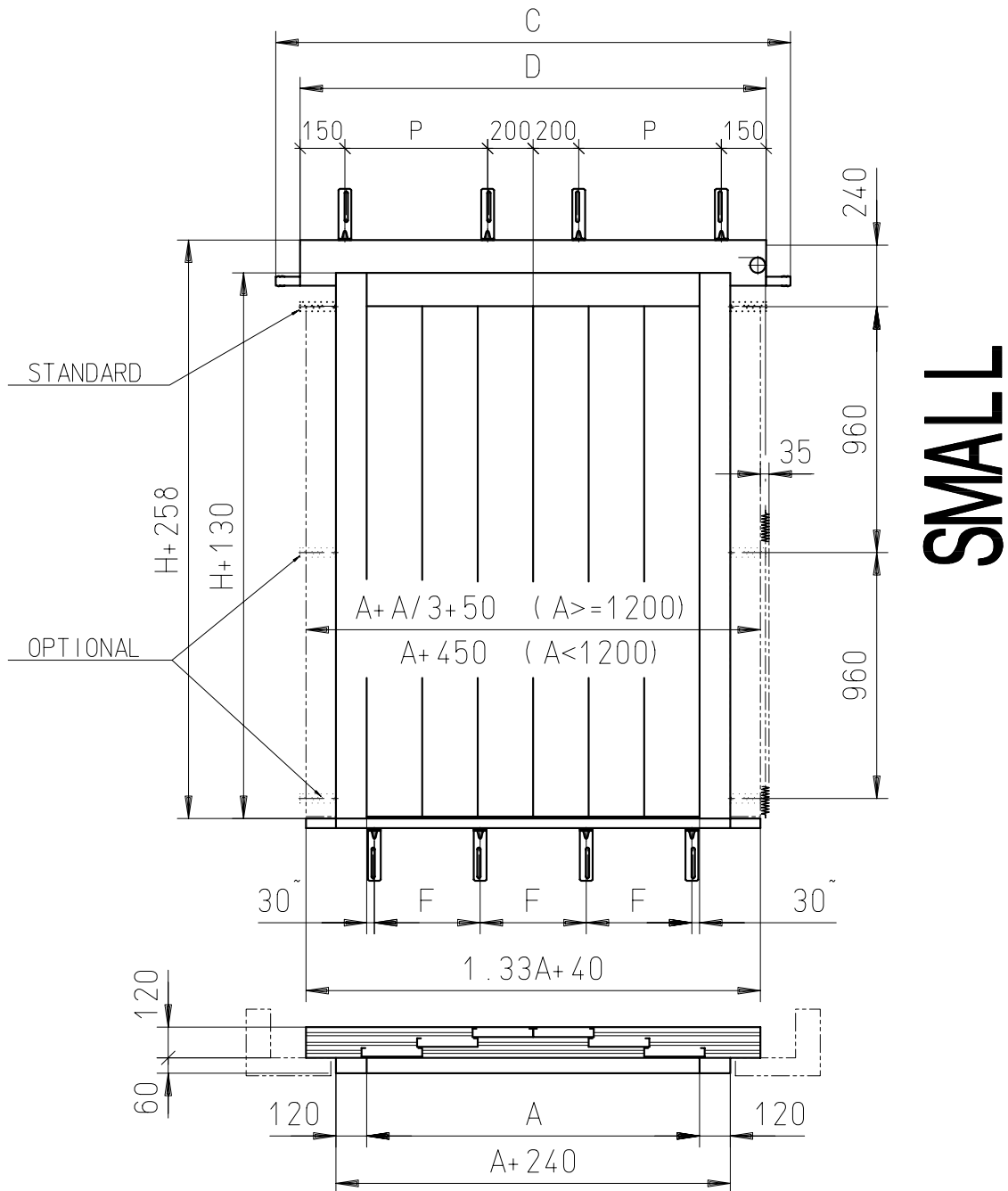

A	900	950	1000	1050	1100	1150	1200	1250	1300	1350	1400	1450	1500	1550	1600	1650	1700	1750
C	1388	1438	1538	1588	1638	1688	1738	1788	1888	1938	1988	2038	2138	2188	2238	2288	2338	2338
D	1280	1280	1280	1280	1280	1280	1580	1580	1580	1580	1580	1880	1880	1880	1880	1880	1880	1880
F	420	445	313	330	346	363	380	396	413	430	446	347.5	360	372.5	385	397.5	410	422.5
P	NR. 3						NR. 4						NR. 5					
	290	290	290	290	290	290	440	440	440	440	440	590	590	590	590	590	590	590
	NR. 4																	

Serie "Q" DIN 18091 SMALL

FIXING STANDARD

01_06_00_01REV00

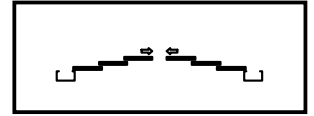

L6C

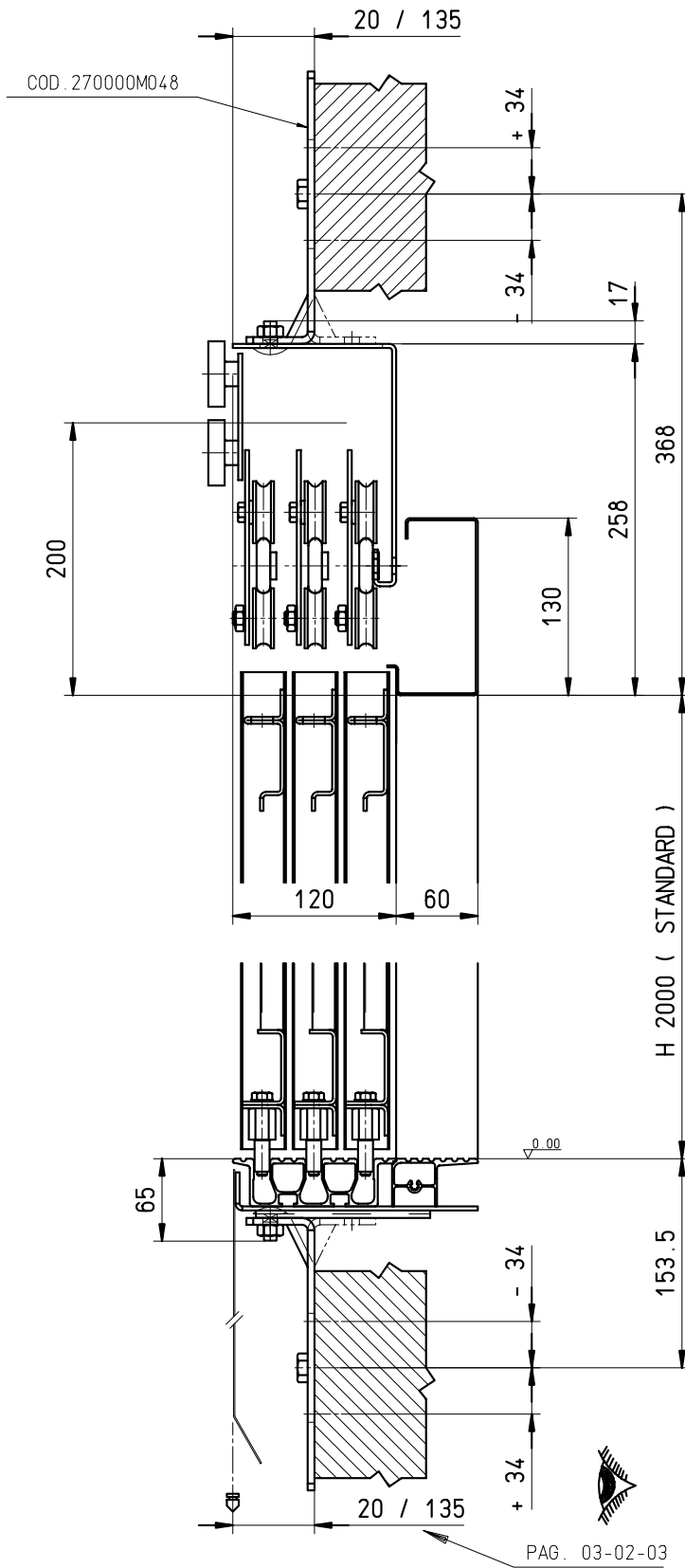

SMALL

Serie "Q" DIN 18091 SMALL

FIXING WITH UNI STRUTS

01_06_00_01REV00

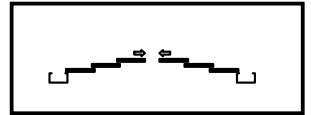

L6C

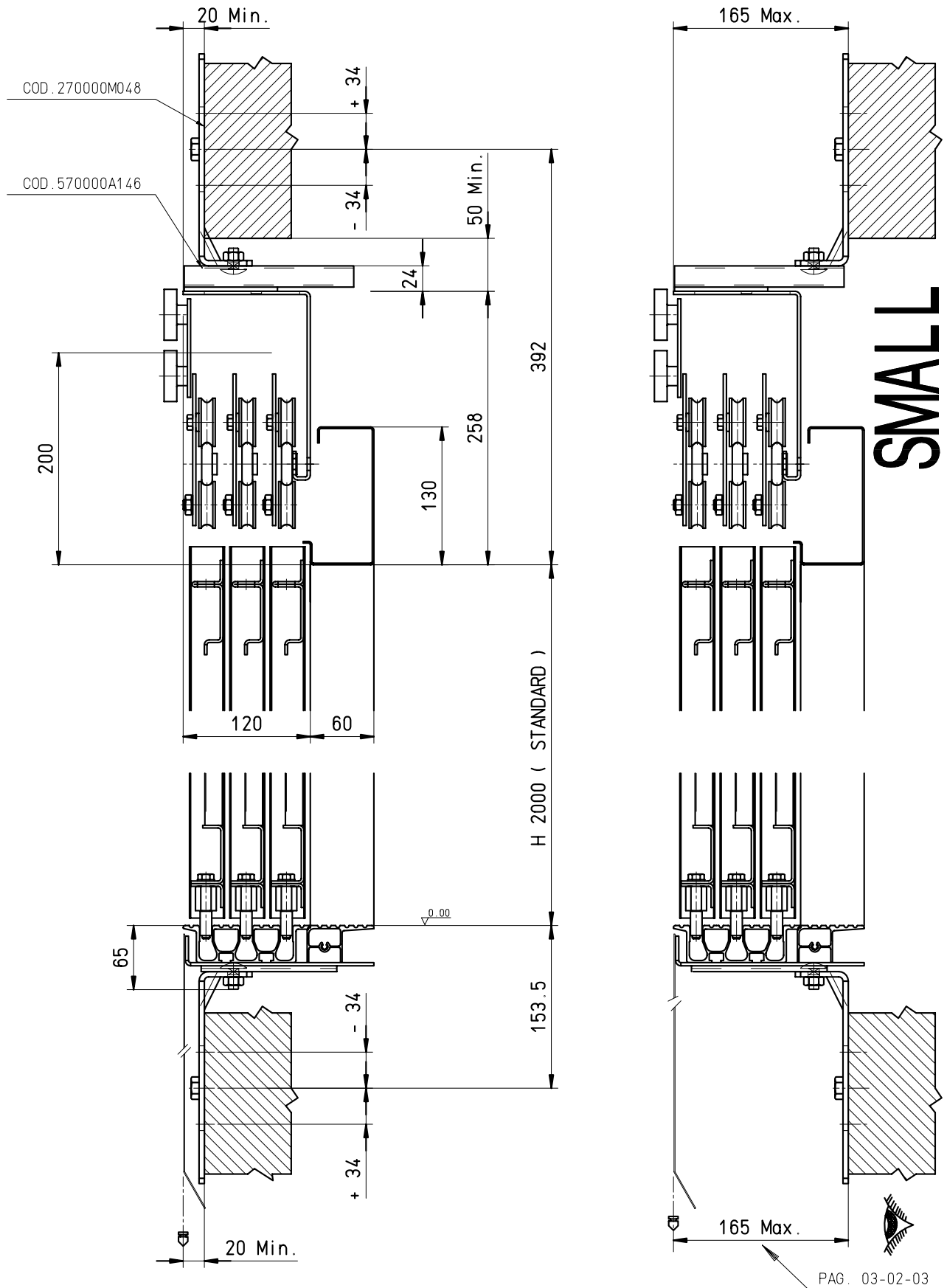

L6C

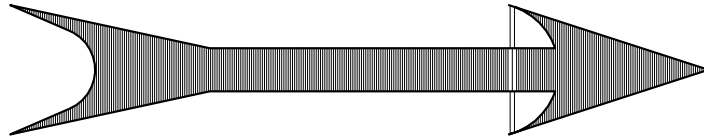

Serie "Q" DIN 18091

STANDARD

01_06_00_01REV00

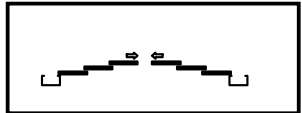

L6C

A 1800 - 4000

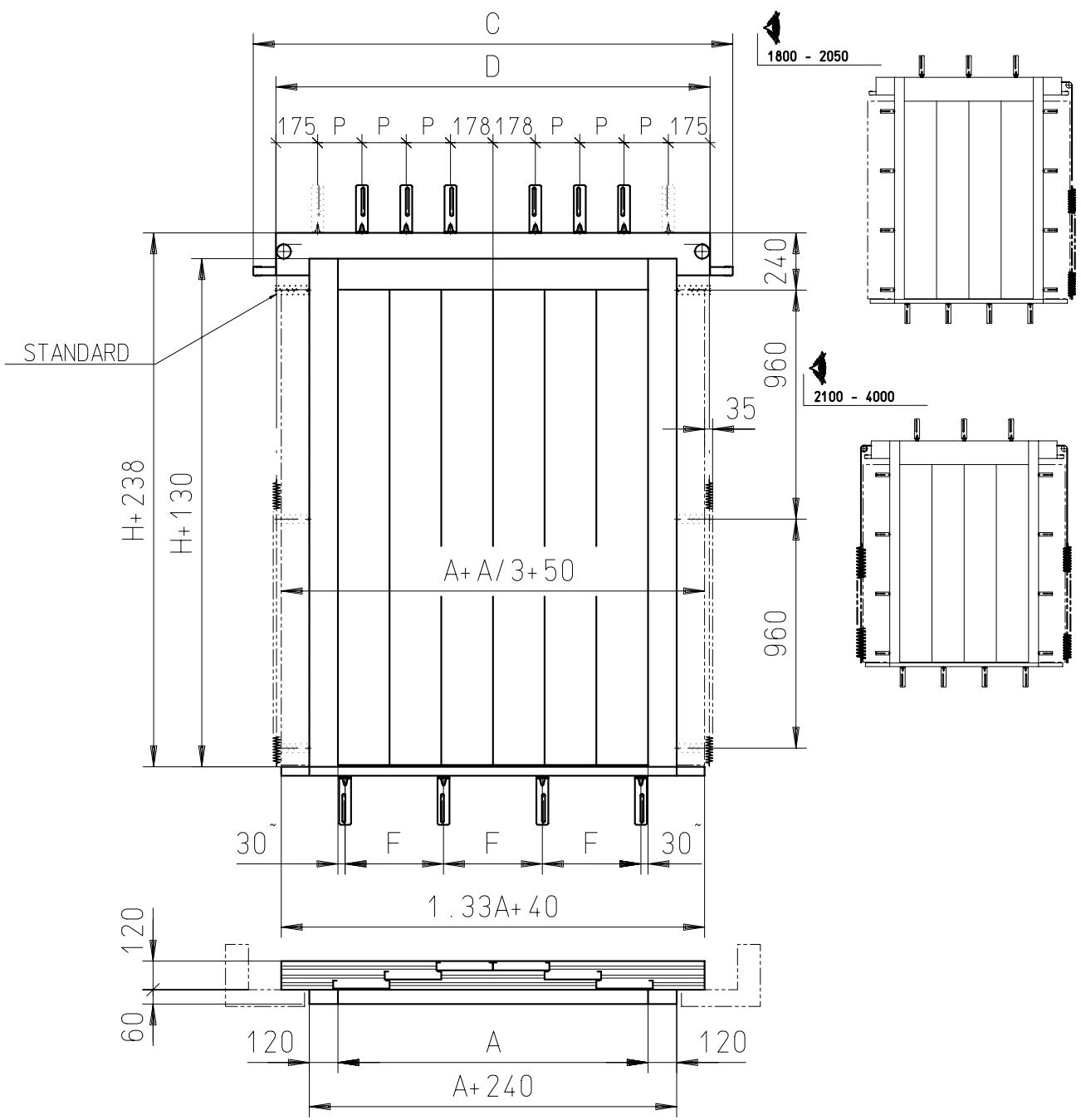

A	1800	1900	2000	2100	2200	2300	2400	2500	2600	2700	2800	2900	3000	3100	3200	3300	3400	3500	3600	3700	3800	3900	4000
C	2488	2588	2688	2872	2972	3072	3278	3378	3478	3678	3778	3878	4078	4178	4278	4478	4578	4678	4878	4978	5078	5278	5378
D	2424	2424	2424	2808	2808	2808	3192	3192	3192	3576	3576	3576	3960	3960	3960	4344	4344	4344	4728	4728	4728	5112	5112
F	435	368	388	408	428	448	390	406	423	440	391	405	420	434	448	462	477	491	505	520	534	548	562
	NR. 5		NR. 6			NR. 7				NR. 8													
P	429.5	429.5	429.5	525.5	525.5	525.5	311	311	311	359	359	359	407	407	407	455	455	455	503	503	503	551	551
	NR. 4			NR. 6			NR. 10																

Serie "Q" DIN 18091

FIXING STANDARD

01_06_00_01REV00

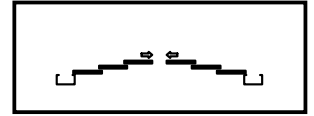

L6C

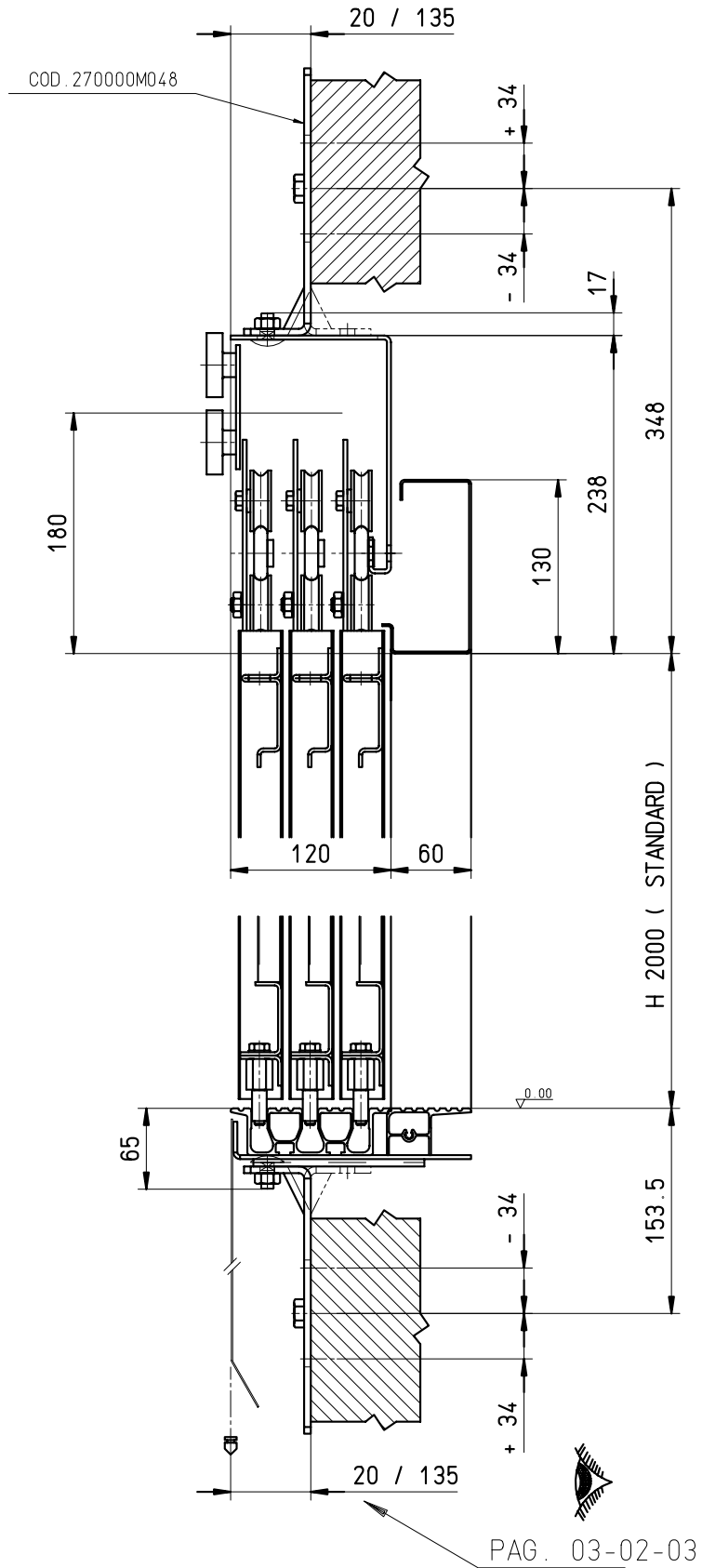

Serie "Q" DIN 18091

FIXING WITH UNI STRUTS

01_06_00_01REV00

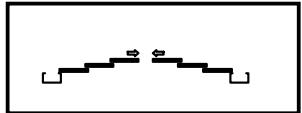

L6C

